

# KINGSGATE SUBDIVISION

## UNION TOWNSHIP SECTION 17, TOWN 3, RANGE 2

168.000

HOUSE NUMBERS

KINGSGATE

KINGSGATE

KINGSGATE

1	7513	KINGSGATE WAY
2	7511	"
3	7509	"
4	7507	"
5	7505	"
6	7503	"
7	7501	"
54	7501	QUEEN ANNS CT
55	7503	"
56	7505	"
57	7507	"
58	7509	"
59	7511	"
60	7519	"
61	7521	"
62	7523	"
63	7525	"
64	7527	"
65	7529	"
66	7531	"
67	7533	KINGSGATE WAY
68	7531	"
69	7529	"
70	7527	"
71	7523	"
72	7521	"
73	7519	"
74	7517	"
117	7564	KNIGHTS KNOLL
118	7562	"
119	7560	"
120	7558	"
121	7556	"
122	7554	"
123	7552	"
124	7550	"
125	7548	"
126	7546	"
127	7544	"
128	7542	"
129	7540	EXCHEQUER CT
130	7538	"
131	7536	"
132	7534	"
133	7532	"
134	7530	"
135	7528	KINGSGATE WAY
136	7526	"
137	7524	"
138	7522	"
139	7520	"
140	7518	"
141	7516	"
142	7514	"
143	7512	"
144	7510	PARLIAMENT CT
145	7508	"
146	7506	"
147	7504	"
148	7502	"
149	7500	"
150	7498	"
151	7496	BLACKSTONE CT
152	7494	"
153	7492	"
154	7490	"
155	7488	"
156	7486	"
157	7484	"
158	7482	DOVER DRIVE
159	7480	"
160	7478	"
161	7476	"
162	7474	"
163	7472	"
164	7470	"
165	7468	"
166	7466	"
167	7464	"
168	7462	"
169	7460	"
170	7458	DOVER DRIVE
171	7456	"
172	7454	"
173	7452	"
174	7450	"
175	7448	GRAYSTONE CT
176	7446	"
177	7444	"
178	7442	"
179	7440	"
180	7438	"
181	7436	"
182	7434	"

183	7512	KNIGHTS KNOLL
184	7510	"
185	7508	"
186	7506	"
187	7504	"
188	7502	"
189	7498	"
190	7496	"
191	7494	"
192	7492	"
193	7482	"
194	7480	"
195	7478	"
196	7476	"
197	7468	GRAYSTONE CT
198	7470	"
199	7472	"
200	7474	"
201	7484	"
202	7486	"
203	7488	"
204	7490	"
205	7494	DOVER DRIVE
206	7492	"
207	7490	"
208	7495	"
209	7493	"
210	7491	"
211	7489	"
212	7522	OLD ENGLISH DR
213	7520	"
214	7518	"
215	7516	"
216	7514	"
217	7512	"
218	7521	"
219	7519	"
220	7517	"
221	7515	"
222	7513	"
223	7511	"
224	7462	"
225	7460	"
226	7458	"
227	7456	"
228	7454	"
229	7452	"

230	7546	HALIFAX CT
231	7544	"
232	7542	"
233	7540	"
234	7538	"
235	7536	"
236	7534	"
237	7532	"
238	7461	SAXONY DR
239	7459	"
240	7457	"
241	7455	"
242	7453	"
243	7451	"
244	7441	"
245	7439	"
246	7437	"
247	7435	"
248	7433	"
249	7431	"
250	7552	"
251	7554	"
252	7556	"
253	7558	"
254	7561	"
255	7563	"
256	7565	"
257	7567	"
258	7569	"
259	7571	"
260	7573	"

CHATEAU CT

INTERSTATE ROUTE 75

SEE PAGE 19

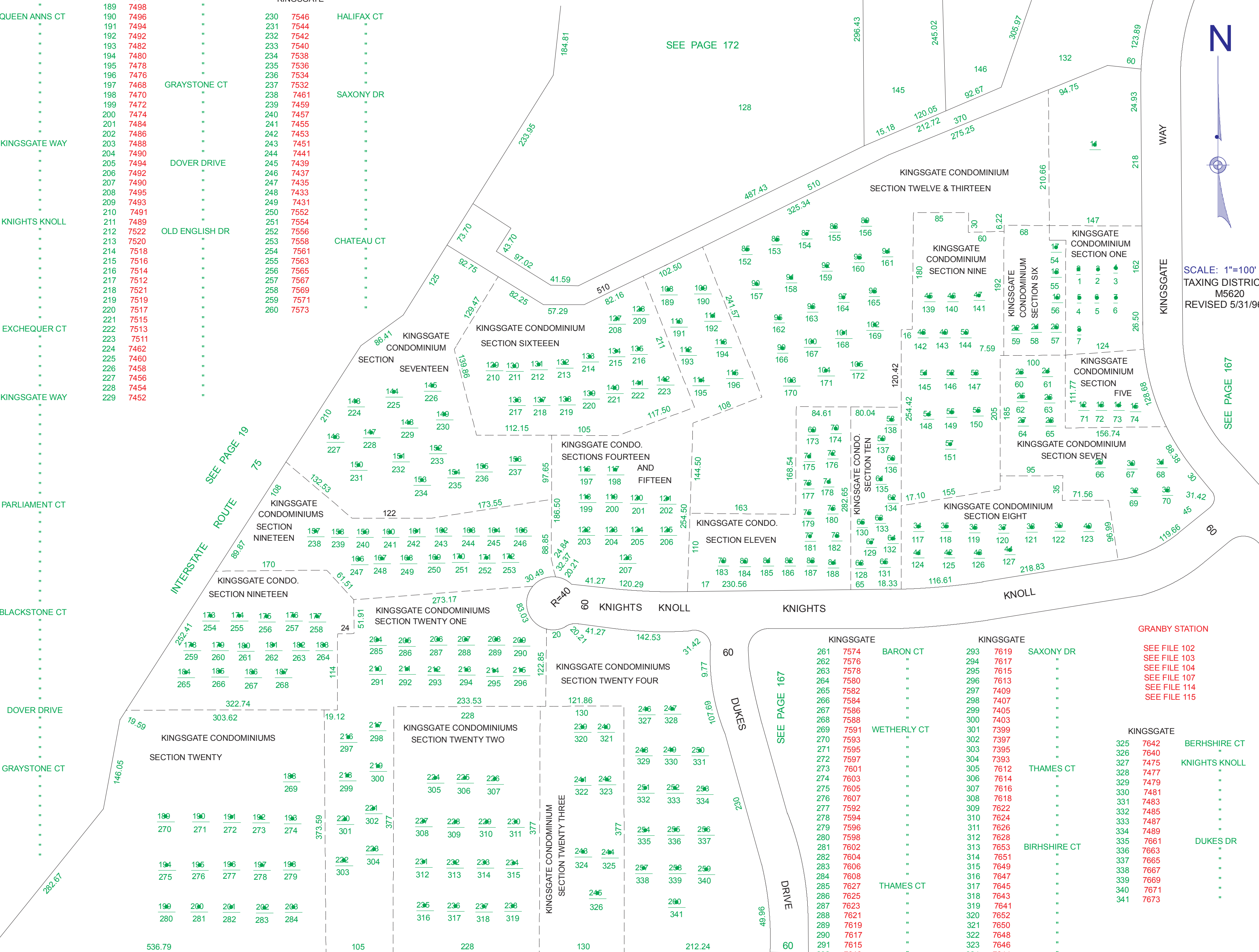

SCALE: 1"=100'  
TAXING DISTRICT:  
M5620  
REVISED 5/31/96

SEE PAGE 167

KINGSGATE		KINGSGATE			
261	7574	BARON CT	293	7619	SAXONY DR
262	7576	"	294	7617	"
263	7578	"	295	7615	"
264	7580	"	296	7613	"
265	7582	"	297	7409	"
266	7584	"	298	7407	"
267	7586	"	299	7405	"
268	7588	"	300	7403	"
269	7591	WETHERLY CT	301	7399	"
270	7593	"	302	7397	"
271	7595	"	303	7395	"
272	7597	"	304	7393	"
273	7601	"	305	7612	THAMES CT
274	7603	"	306	7614	"
275	7605	"	307	7616	"
276	7607	"	308	7618	"
277	7592	"	309	7622	"
278	7594	"	310	7624	"
279	7596	"	311	7626	"
280	7598	"	312	7628	"
281	7602	"	313	7653	BIRSHIRE CT
282	7604	"	314	7651	"
283	7606	"	315	7649	"
284	7608	"	316	7647	"
285	7627	THAMES CT	317	7645	"
286	7625	"	318	7643	"
287	7623	"	319	7641	"
288	7621	"	320	7652	"
289	7619	"	321	7650	"
290	7617	"	322	7648	"
291	7615	"	323	7646	"
292	7613	"	324	7644	"

GRANBY STATION  
SEE FILE 102  
SEE FILE 103  
SEE FILE 104  
SEE FILE 107  
SEE FILE 114  
SEE FILE 115

KINGSGATE  
325 7642 BERHSHIRE CT  
326 7640 " "  
327 7475 KNIGHTS KNOLL  
328 7477 " "  
329 7479 " "  
330 7481 " "  
331 7483 " "  
332 7485 " "  
333 7487 " "  
334 7489 " "  
335 7661 " "  
336 7663 " "  
337 7665 " "  
338 7667 " "  
339 7669 " "  
340 7671 " "  
341 7673 " "