



BCEO Tax Map Department
Administration Building
130 High Street
Hamilton, Ohio 45011
[Tel] 513.887.3500 [Fax] 513.887.3633
WWW.BCEO.ORG



PLOT DATE: 12/8/2008

VENTER
REILY TWP
Section 03, Town 4, Range 1
BUTLER COUNTY, OHIO

FOR INFORMATIONAL PURPOSES ONLY. NOT INTENDED FOR USE AS A SURVEY.

Scale: 1"=100'

039000

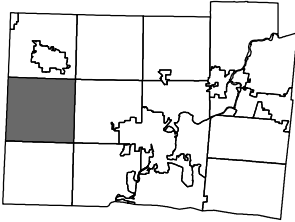

Revised Date: 2/14/2005
Taxing District: J4320
2nd Tax Dist: NONE

See Page 004.00
REILY TWP

OXFORD REILY RD

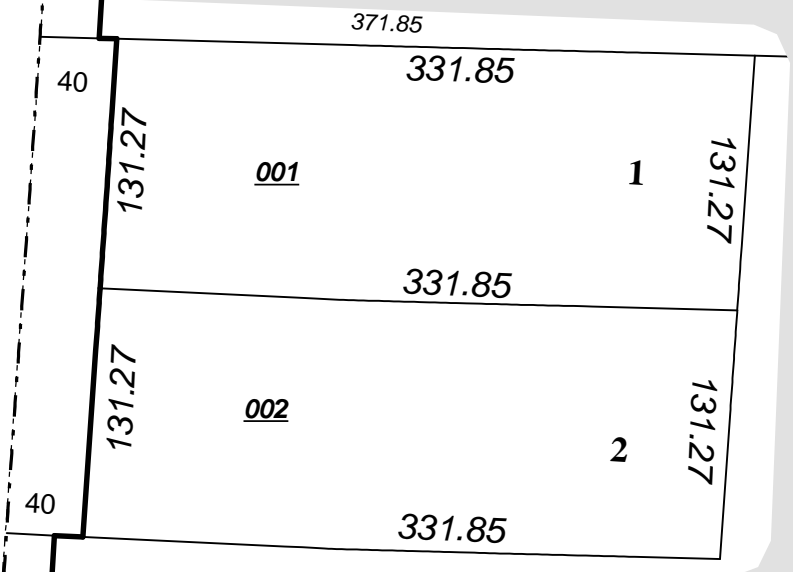

See Page 003.00
REILY TWP