

BUTLER COUNTY, OHIO.
FAIRFIELD TOWNSHIP

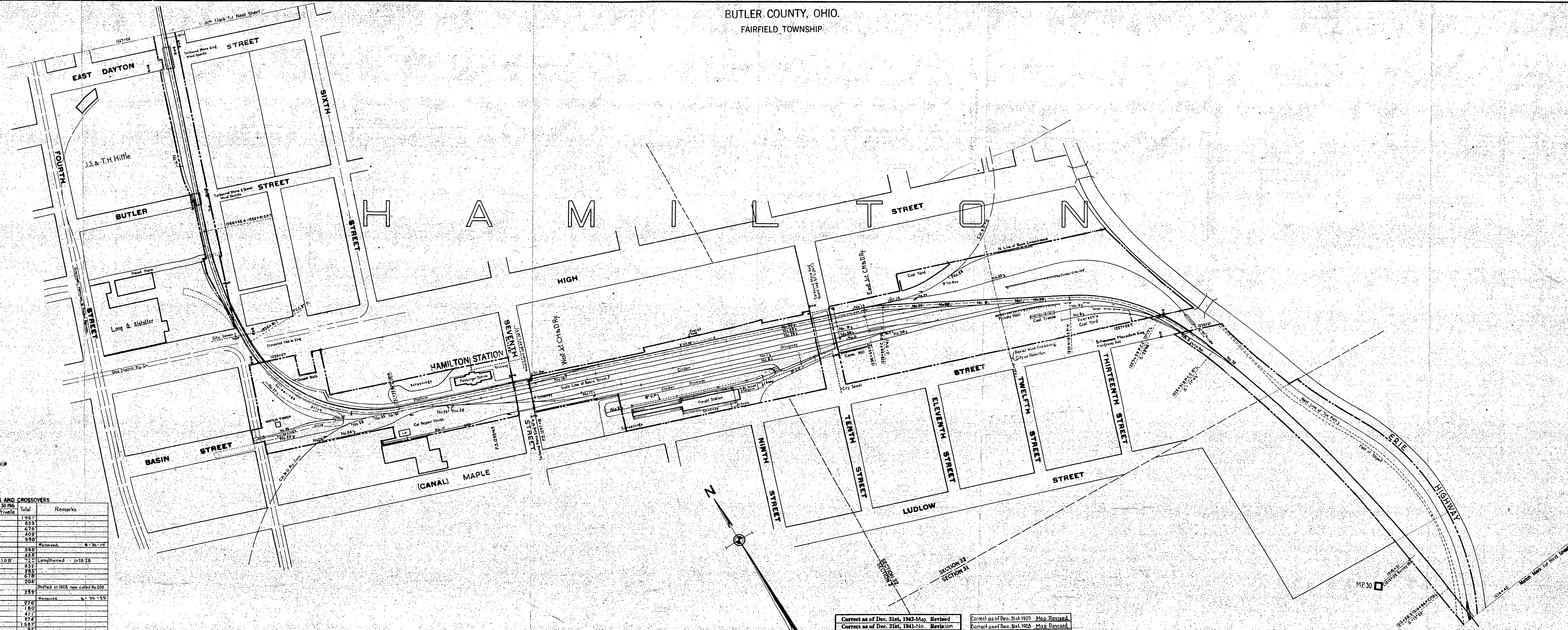

SCHEDULE OF SIDINGS AND CROSSOVERS

Siding Number	Location	Class	Length June 30, 1910 R.R. Co. Private	Total	Remarks
1	Hamilton Corporation	B	981	1961	
2	"	Y	853	853	
3	"	Y	876	876	
4	"	B	409	409	
5	"	B	990	990	
6	"	B	388	388	Removed 6-30-19
7	"	Y	486	486	
12	"	B	617	1018	Lengthened 10-26-28
13	"	Y	832	832	
14	"	Y	285	285	
17	"	B	676	676	
18	"	Y	204	204	
19	"	Y	263	263	Shifted in 1928 now called No. 30
21	"	B	276	276	Removed 6-30-19
22	"	B	276	276	
23	"	B	180	180	
24	"	B	411	411	
25	"	B	274	274	
26	"	Y	1587	1587	
27	"	Y	84	84	
29	"	Y	1522	1522	
30	"	Y	5646	5646	
32	"	Y	451	451	Lengthened in 1928
33	"	B	366	366	
35	"	B	506	506	
36	"	B	651	651	
37	"	B	287	287	
38	"	Y	457	457	
40	"	B	442	442	
41	"	B	140	150	Added 9-16-27
830	"	B	196	196	Added in 1928 formerly No. 19

AB OF	REVISION
DEC. 31	YES NO
1907	
1908	
1909	
1910	
1911	
1912	
1913	
1914	
1915	
1916	
1917	
1918	
1919	
1920	
1921	
1922	
1923	
1924	
1925	
1926	
1927	
1928	
1929	
1930	

Correct as of Dec. 31st, 1955-Map Revised
Correct as of Dec. 31st, 1954-Map Revised
Correct as of Dec. 31st, 1953-Map Revised
Correct as of Dec. 31st, 1952-Map Revised
Correct as of Dec. 31st, 1951-Map Revised
Correct as of Dec. 31st, 1950-Map Revised
Correct as of Dec. 31st, 1949-Map Revised
Correct as of Dec. 31st, 1948-Map Revised
Correct as of Dec. 31st, 1947-Map Revised
Correct as of Dec. 31st, 1946-Map Revised
Correct as of Dec. 31st, 1945-Map Revised
Correct as of Dec. 31st, 1944-Map Revised
Correct as of Dec. 31st, 1943-Map Revised

Correct as of Dec. 31st, 1942-Map Revised
Correct as of Dec. 31st, 1941-Map Revised
Correct as of Dec. 31st, 1940-Map Revised
Correct as of Dec. 31st, 1939-Map Revised
Correct as of Dec. 31st, 1938-Map Revised
Correct as of Dec. 31st, 1937-Map Revised
Correct as of Dec. 31st, 1936-Map Revised
Correct as of Dec. 31st, 1935-Map Revised
Correct as of Dec. 31st, 1934-Map Revised
Correct as of Dec. 31st, 1933-Map Revised
Correct as of Dec. 31st, 1932-Map Revised
Correct as of Dec. 31st, 1931-Map Revised
Correct as of Dec. 31st, 1930-Map Revised

Correct as of Dec. 31st, 1929-Map Revised
Correct as of Dec. 31st, 1928-Map Revised
Correct as of Dec. 31st, 1927-Map Revised
Correct as of Dec. 31st, 1926-Map Revised
Correct as of Dec. 31st, 1925-Map Revised
Correct as of Dec. 31st, 1924-Map Revised
Correct as of Dec. 31st, 1923-Map Revised
Correct as of Dec. 31st, 1922-Map Revised
Correct as of Dec. 31st, 1921-Map Revised
Correct as of Dec. 31st, 1920-Map Revised
Correct as of Dec. 31st, 1919-Map Revised
Correct as of Dec. 31st, 1918-Map Revised
Correct as of Dec. 31st, 1917-Map Revised

Sheet No. S.T. 24, V. 10, Ohio, Pittsburg, Cincinnati, Chicago & St. Louis
Railway from survey station 1214+40 to survey station 1267+20

PHILA. BALTO. & WASHINGTON R. R.
FORMERLY
STATION MAP - TRACKS AND STRUCTURES
PITTSBURGH, CINCINNATI, CHICAGO & ST. LOUIS RY.
RICHMOND DIVISION
STATION 1214+40 TO STATION 1267+20
SCALE: 1 INCH = 100 FEET
JUNE 30, 1918
OFFICE OF VALUATION ENGINEER
PITTSBURGH, PA.

V.10
OHIO
S.T.24