

AUTHORITY	DATE INSTALLED OR RETIRED	DESCRIPTION
C-21789 A.F.E.-4466	Installed April 23, 1924	Rearrangement of tracks at plant of Champion Coated Paper Co., partly in connection with construction of highway bridge across Miami River at this point. Track 8602(1) was shortened 72' by moving main track turnout to station 153+07.6 making T-8602(1) now 1129' in length. Track 8602(3) was shifted nearer to North D st and changed to connect to T-8602(1) with and Miami Cons. Dist. removed 29' of turnout end, making T-8602(3) now 1580' long. T-8602(5) was extended from old length of 449' to a new length of 719' by moving main line turnout to station 157+81. 71' of this extension was obtained by the shifting of T-8602(3) as stated above. The remaining 199' having been installed by the Miami Cons. Dist. which under an ICC ruling cannot be capitalized nor reported under 10.3. Accounting interpretations (Case 205). Railroad Co. retains ownership of these tracks.
C-23662 A.F.E. 6601	Installed Aug. 22, 1921 Retired under A.F.E. 16856	Donation to D.D. Co. by Champion Coated Paper Co. of 90' of T-8602(2) from P.S. to clearance point. P.S. of track at station 150+93.4.
C-23463 A.F.E. 6435	Retired June 16, 1925	Changes at plant of Champion Coated Paper Co. Dead end track, 160' long, formerly 400' on right of station 142+25, removed. P.S. of T-8602(4) moved to station 4+80 in T-8602(3) making (4) 12' shorter. Present length is 543'. P.S. of T-8602(6) moved north to station 157+15.5 making (6) 19' longer. Present length is 1195'. Tracks owned by R.R. Co.
C-23726 A.F.E. 5706	Retired Jan. 2, 1924	Sale of 3303 sq. ft. of Parcel No. 30, 800 sq. ft. of Parcel No. 39, 245 sq. ft. of Parcel No. 40, and 840 sq. ft. of Parcel No. 41, of a total of 5188 sq. ft. on right between stations 127+45 and 150+10, to Miami Conservancy District by deed dated Dec. 16, 1923. D.E.A. File 13.
C-25582 A.F.E.-7379	Completed Nov. 28, 1925	Rearrangement of tracks at plant of Champion Coated Paper Company. Retirement of 1285' of track 8602(1) including the No. 7 turnout of track 8602(3) and 2 crossing frogs owned jointly with Ohio Electric Railway. Original length of track was 1184' and of this 471' difference 22' was retired under A.F.E. 4466, 266' including turnout remains on ground as stub end track with P.S. in main track at station 153+03 and 153' was incorporated with newly constructed track 8602(3) L-664' including a No. 8 turnout with P.S. in track 8602(2) opposite sta. 12+84. Retirement of entire track 8602(2) L-421' including a No. 5 turnout. P.S. was in track 8602(1) on right of station 153+402. Throwing and extending track 8602(5) and installing a new No. 6 turnout on north end and refitting 80' of 70 ft. track. P.S. in main track at station 150+681. New L-1162'. Retirement of 897' of old track 8602(7) including a No. 6 turnout. P.S. formerly in track 8602(1) on right of station 154+954. The remaining portion of this track was incorporated with newly constructed track 8602(7) L-1835' including a No. 8 turnout. P.S. in track 8602(6) at station 16203. Capitalization of 537' of former industrial track 8602(8) P.S. was in track 8602(7) on right of station 155+304. This 537' was incorporated with newly constructed track 8602(8) L-2154' including No. 9 turnout and 2 special crossing frogs owned jointly with Ohio Electric Railway Co. P.S. in main track at station 156364. Construction of the following tracks: Track 8602(1) L-639' including a No. 8 turnout. P.S. in track 8602(6) at station 16303; Track 8602(2) L-754' including a No. 8 turnout. P.S. in track 8602(8) at station 70633; Railroad Co. town-all tracks as rearranged under this authority. Retirement of grade crossing under old tracks 8602(1) and 8602(2) on right of station 155+304 and construction of catch basin and manhole in North B st on right of station 129+04; concrete levee on right of station 129+00' and 2 grade crossings, one on right of station 129+70' under track 8602(6) and one on right of station 152+70' under track 8602(5).
C-24627 A.F.E. 9619	Completed Jan. 12, 1926	Sale of land to The Champion Coated Paper Co. by deed dated Dec. 29, 1925 being 301 sq. ft. of Parcel No. 39, 59 sq. ft. of Parcel No. 40, 3559 sq. ft. of Parcel No. 41 and 17043 sq. ft. of Parcel No. 42. See land schedule.
C-29075 A.F.E. 1244	Completed Oct. 1921	Sewer assessments - Lots 1460 & 15422. sta. 120+75 & 110+20.
C-34647 A.F.E. 16856	Retired Mar. 15, 1930	Retirement of T-8602(9). Sta. 150+93.4.

Continued On Typed List

SCHEDULE FOR LAND SALES, ETC.

PARCEL NO.	CUSTOMER'S NO.	KIND OF INSTRUMENT	DATE OF INSTRUMENT	GRANTOR	GRANTEE	RECORDED			AREA	REMARKS
						BOOK	PAGE	DATE		
30	D.C. Dec'd	Deed	July 9 1923	B. & O.R.R.	J.K. Cullen				8490	R.R. D. Claims oil right, title & interest in parcel No. 46 map 8-3, A.F.E.

BUTLER CO. OHIO
ST. CLAIR TWP
T.2N-R.3E

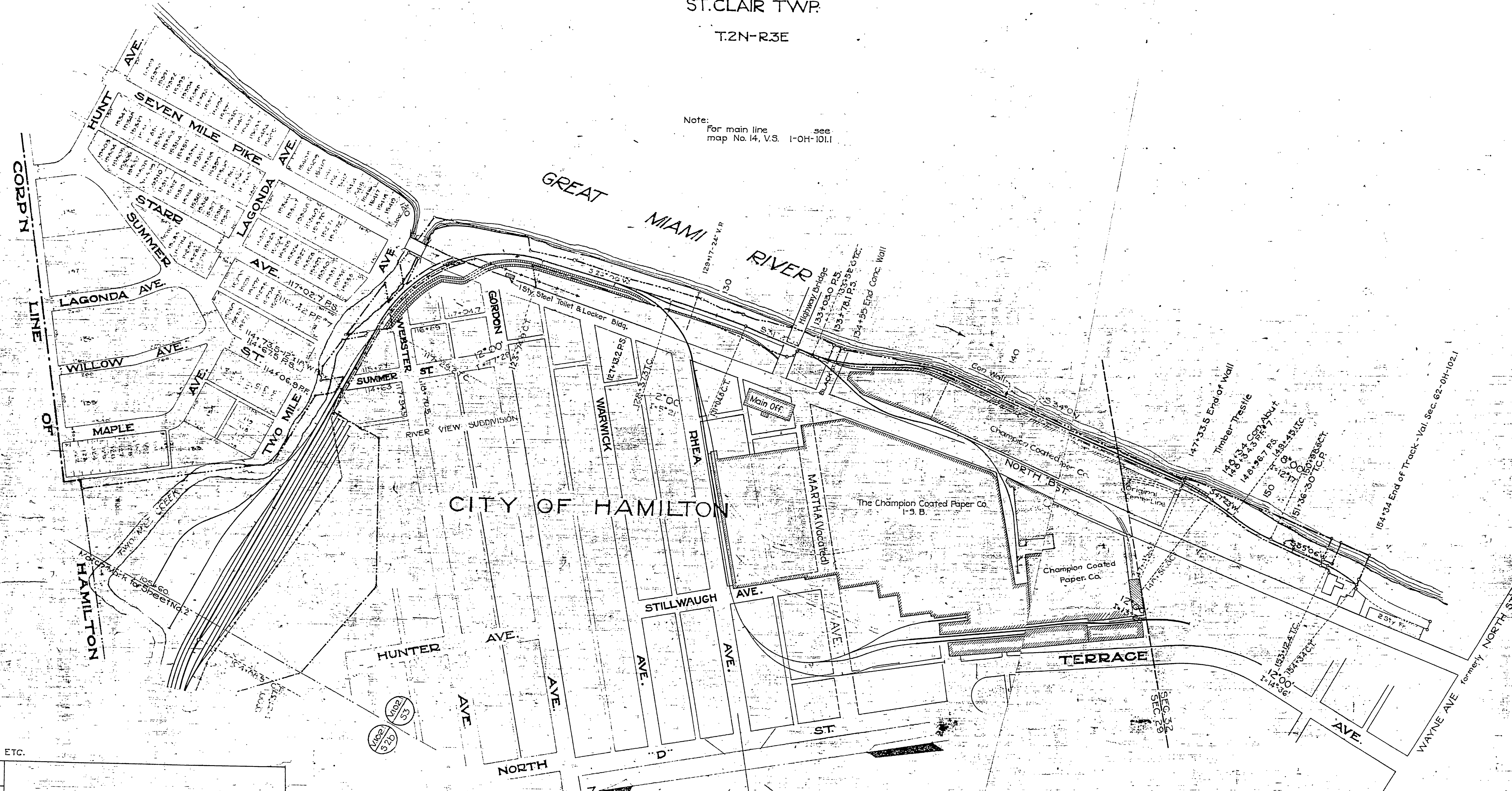

Note: For main line see map No. H, V.3. 1-011-1011

Sheet No. 3 of 3 primary and 3 supplemental sheets.

RIGHT-OF-WAY AND TRACK MAP

THE BALTIMORE AND OHIO RAILROAD COMPANY

OPERATED BY

THE BALTIMORE AND OHIO RAILROAD COMPANY

TOLEDO-INDIANAPOLIS DIV. HAMILTON-BELT RAILWAY

STATION 105+600 TO STATION 154+34

SCALE: 1 IN. = 200 FT.

JUNE 30, 1918

OFFICE OF VALUATION ENGINEER
BALTIMORE, MD.

REVISED	DATE	BY	REASON
1	1918		
2	1918		
3	1918		
4	1918		
5	1918		
6	1918		
7	1918		
8	1918		
9	1918		
10	1918		

1021
3

(Cop. Apr. 1918 WWV)