



Hamilton Road on line between Mason and Adams Townships

James W. Shields 1964
Elizabeth Shields 1964
Sarah P. King 1870
Thomas I. Shields 1870
Maria R. Shields 1870

Road land in Hamilton County

MORGAN TOWNSHIP

REPRODUCED FROM MAP OF BUTLER COUNTY, OHIO
by John Crane, Surveyor, HAMILTON 1855

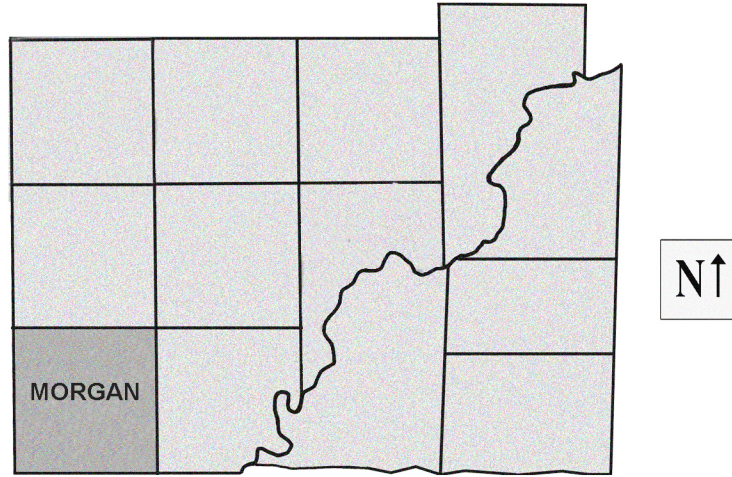

MAP OF MORGAN TOWNSHIP

TP. N^o 3, R. N^o 1 E.



MORGAN

TOWN 3 N. RANGE 1 E.

ST. CHARLES

AUBURN

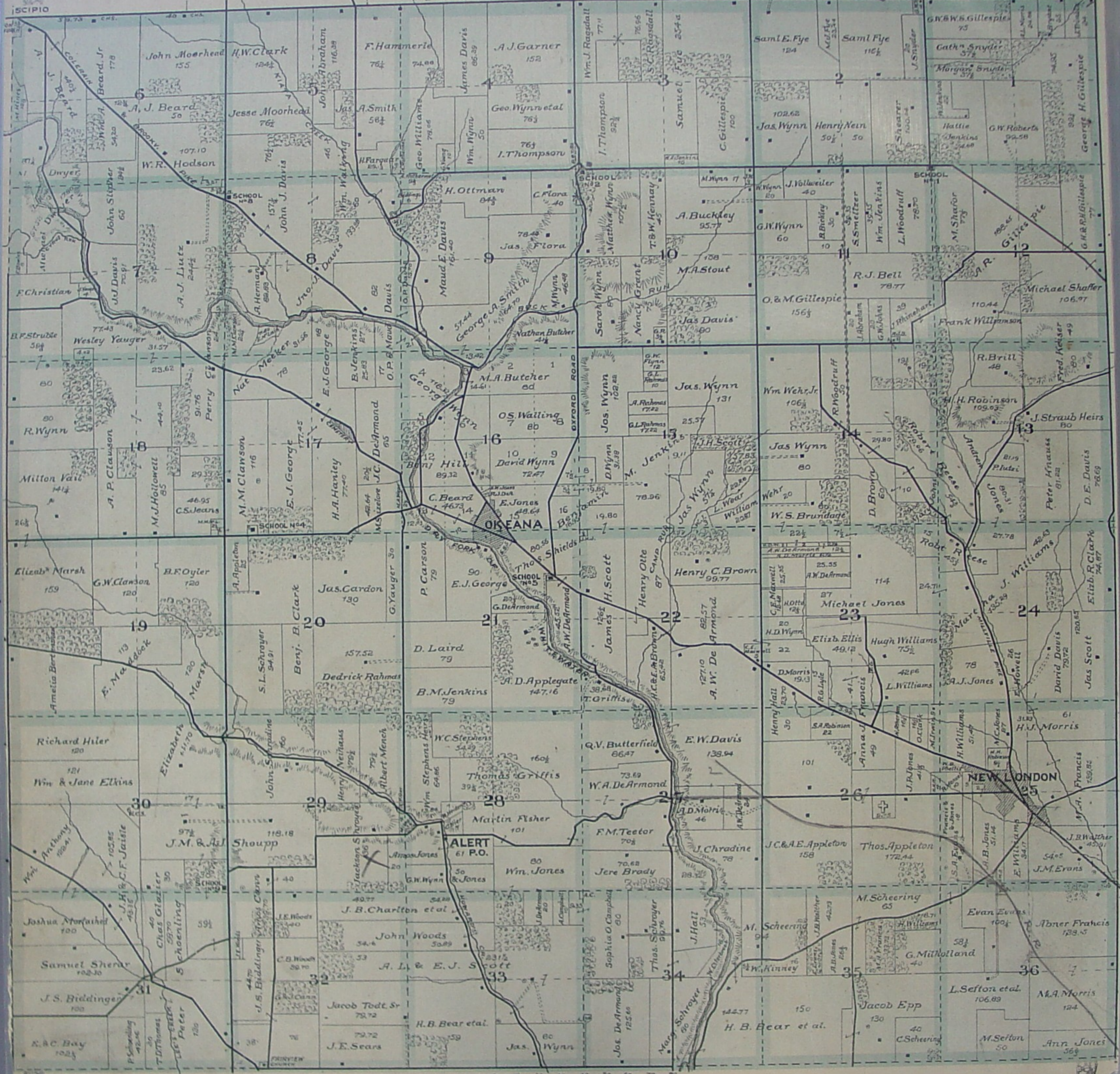

MORGAN

TOWNSHIP

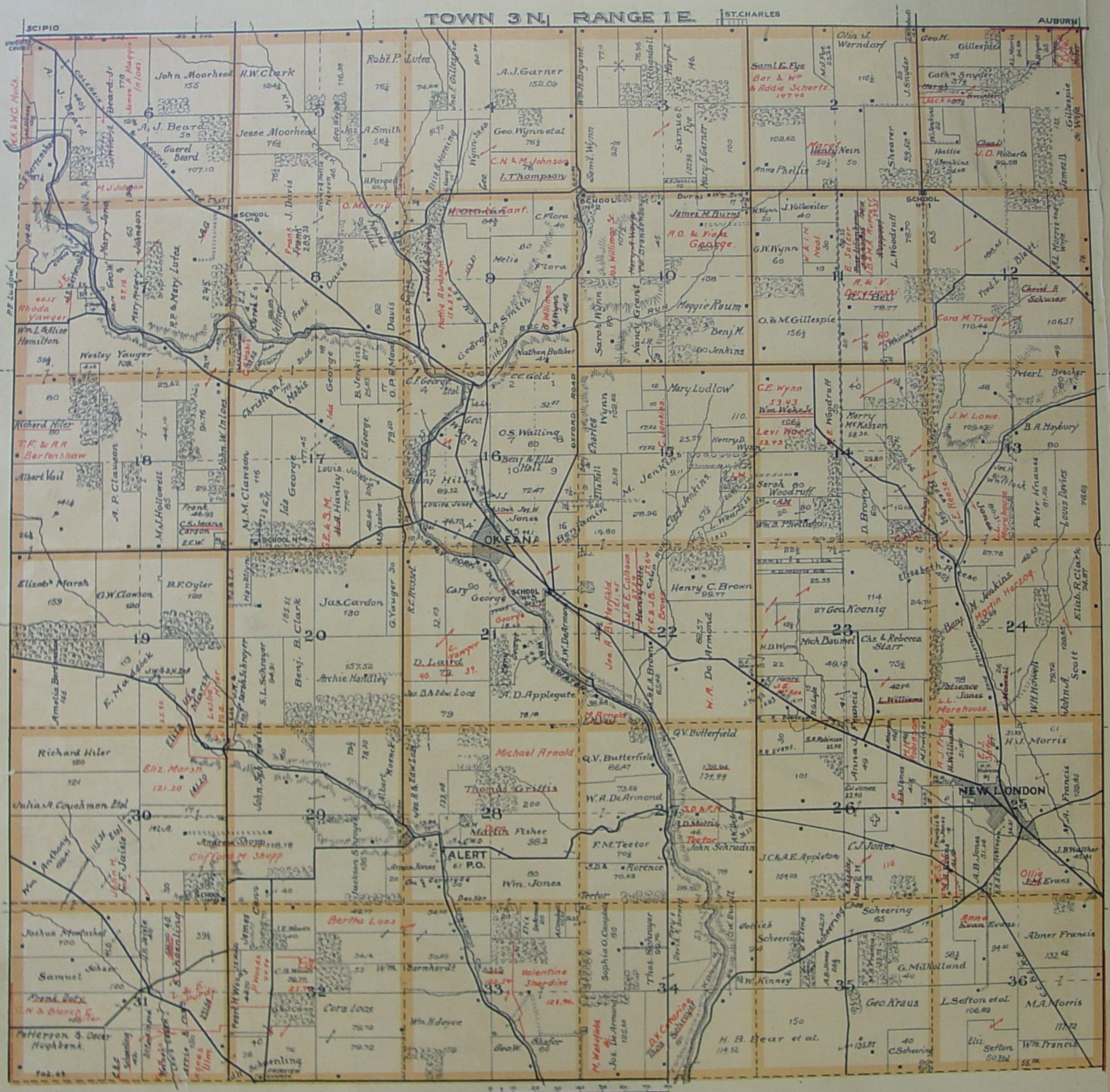

SURFACED ROADS
OTHER ROADS
R. F. D.



Morgan Township

Butler County, Ohio



Town 3 North

Range 1 East

SCALE 2 INCHES=1 MILE

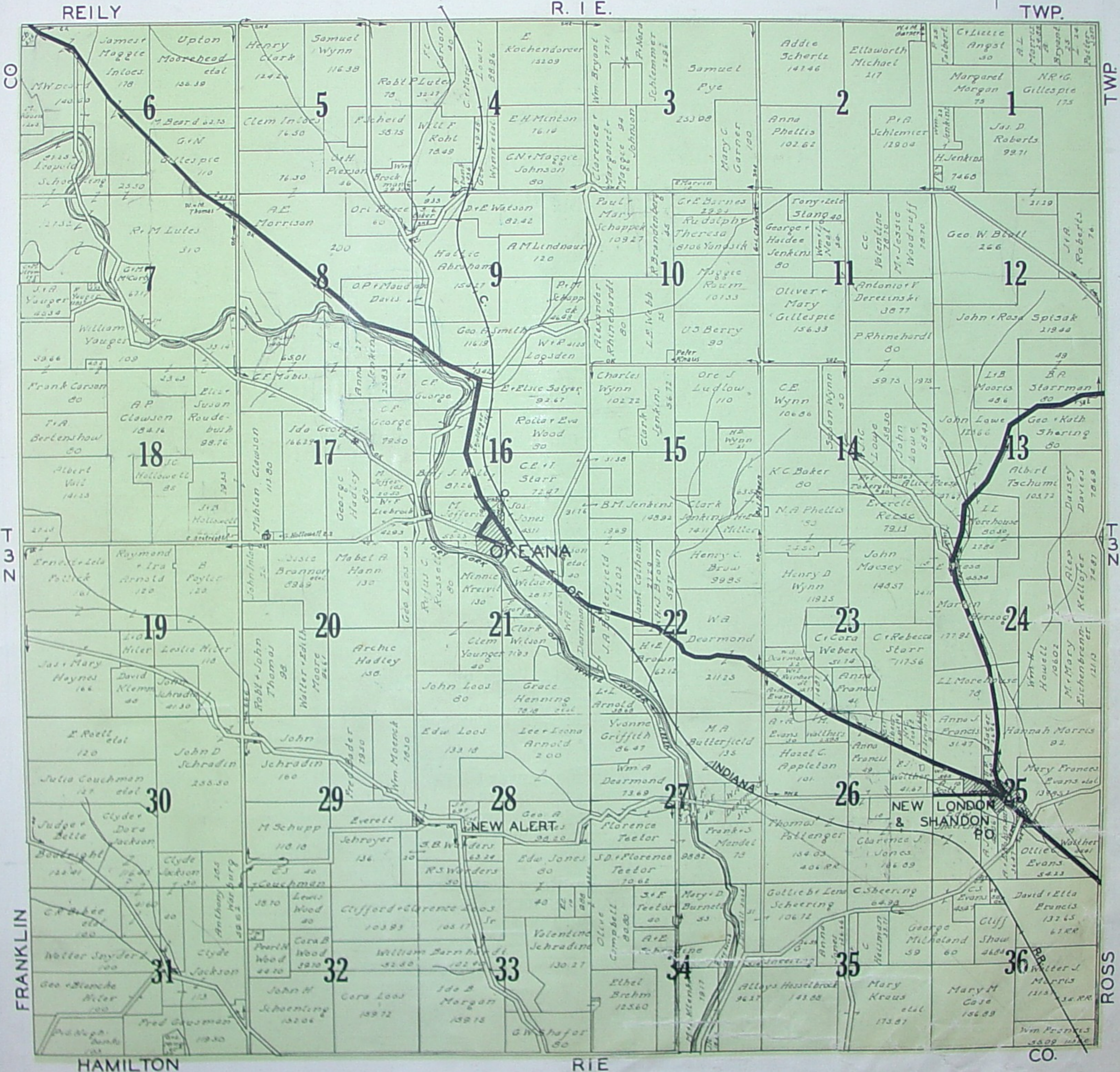

MORGAN

T.3-R.1



- MORGAN TOWNSHIP
- SEC. 1
- A. - Winford Skinnel - 1.581
 - B. - Ralph Bryant, et al - 4.99
 - C. - Yancy Depew - 7.95
 - D. - 241
 - E. - 45
 - F. - Jas. M. & Evelyn Collins - 257
 - G. - Community Gospel Ch. - 1
 - H. - W. R. & M. J. Stephens - 2.7
 - I. - Joe & Helen Metcalf - 2.7
 - J. - Edwin & Stella Petry - 3.95
 - K. - Walter Smith - 3
- SEC. 2
- A. - W. C. & M. E. Garner - 4
- SEC. 3
- A. - J. & J. Alder - 2.75
 - B. - J. D. & M. Wallace - 7.28
 - C. - J. D. & M. Wallace - 5
- SEC. 4
- A. - C. & O. R.R. - 1.2
 - B. - O. R. & J. M. Ogg - 9.36
 - C. - C. & O. R.R. - 10.52
- SEC. 5
- A. - J. D. Powell - 5
- SEC. 6
- A. - Union Church - 3.646
 - B. - T. & D. Morgan - 1
- SEC. 7
- A. - E. Ross - 7.5
 - B. - F. Muller - 3.79
 - C. - Mable Mabis - 2
- SEC. 8
- A. - Delora Wilkins - 7.4
 - B. - Homer Davis, et al - 1
 - C. - L. & D. Phelps - .92
 - D. - H. J. Davis - .9
 - E. - Homer J. Davis - .4
- SEC. 9
- A. - S. Baker - 5.5
 - B. - R. H. Baker - 4.54
 - C. - Fred Tinscher - 1.46
 - D. - B. M. & M. E. Harper - 18.874
 - E. - J. L. Williams - 22.376

- SEC. 10
- A. - C. & B. Stitzel - 3.5
 - B. - Board of Education - .5
 - C. - G. & G. Imhoff - 10
 - D. - A. Lauer - 3.16
 - E. - R. C. Knauer - .31
 - F. - Cecil Denie - 2
- SEC. 11
- A. - A. & C. Hermann - 20
 - B. - Earl & Martha Payne - 28.497
 - C. - J. W. Payne & W. K. - 2
 - D. - Melvin & Norma Wood - 1
 - E. - Fred O'Dell - 10
 - F. - N. D. Jones - .25
 - G. - Clyde & Dorothy Miller - .71
 - H. - Jack Stamper - .71
 - I. - C. L. & F. E. Bonar - 1
 - J. - H. R. White Const. Co. - 1
- SEC. 12
- A. - Nathan B. Jones - 9.75
 - B. - A. W. & Darling - 8.02
 - C. - Ray H. Jr. & Betty Yelton - 2.073
 - D. - Edw. & Edith Tucker - 6
 - E. - A. G. Starrman - 5
 - F. - Leonard Wimmers - 2.393
 - G. - Geo. & Loraine Strong - 2.393
 - H. - Iona Simpson - 1
 - I. - Roy H. Jr. & Betty Yelton - 2.221
 - J. - Frank Lowe - 2.054
 - K. - R. & O. Mallicote - 5
 - L. - Emos Wagers - 2
 - M. - O. E. Pence - 5
 - N. - Othello Hammon - 5.764
 - O. - Edw. & Frances Sauter - 5.541
 - P. - Gladys McMahon - .45
 - Q. - Leslie Schuh - 4
 - R. - Leslie Schuh - 1.43
 - S. - Clem. & Bertha Dryden - 4.175
 - T. - R. J. & Mary Sears - 2.5
 - U. - Ralph Eschenbrenner - 1.62
 - V. - J. H. & Nettie Howell - .9675
 - W. - Edw. Jr. & M. Sauter - .9675
 - X. - David Bidham - 4.89
 - Y. - Butler Rural Elec. Corp., Inc. - 1
 - Z. - W. W. & Fannie Miller - 17.59
- SEC. 13
- A. - R. E. & D. A. Payne - 2.5
 - B. - Rosella Schmidt - 6.83
 - C. - H. & M. Clark - .114
 - D. - Jesse & Coleta Clark - .224
 - E. - Virginia Parks (Lindsey) - 4.125

- SEC. 14
- A. - Louis Kramer - 12.24
 - B. - W. F. Hubbard & Ida Bell - 10
 - C. - Ralph & Anna Dorsey - 8.10
 - D. - Ruth Wilson - 3.75
 - E. - Rufus H. & Mildred Russell - 1.04
 - F. - Jos. W. Geiser - 6.74
 - G. - F. D. Roof - 5.625
 - H. - Ronald Mosley - 5.614
 - I. - Rich. Stinecum - 5.106
 - J. - Ruby Elsassner - 10
 - K. - Elaine Haubner - 6.915
- SEC. 15
- A. - Louis Kramer - 12.24
 - B. - W. F. Hubbard & Ida Bell - 10
 - C. - Ralph & Anna Dorsey - 8.10
 - D. - Ruth Wilson - 3.75
 - E. - Rufus H. & Mildred Russell - 1.04
 - F. - Jos. W. Geiser - 6.74
 - G. - F. D. Roof - 5.625
 - H. - Ronald Mosley - 5.614
 - I. - Rich. Stinecum - 5.106
 - J. - Ruby Elsassner - 10
 - K. - Elaine Haubner - 6.915
- SEC. 16
- A. - Mildred Skjoldager - 18.75
 - B. - Rose Wagner - 3.01
 - C. - R. & M. Platt - 12.03
 - D. - C. M. Turner, et al. - 7.18
 - E. - Ralph & Dorothy Jefferies - 3.53
 - F. - Fred Morgan - 1.8
- SEC. 17
- A. - Cemetery - 1
 - B. - O. J. Handley - 1.45
 - C. - Ralph Jefferies - 20.5
 - D. - Rose Wagner - 3
 - E. - Sherman Baker - 2
 - F. - Clinton Greener - 2.2
 - G. - John & Myrtle Ehler - 1
- SEC. 18
- A. - Clayburne Boatwright - 2.5
 - B. - Church - 1.04

- SEC. 19
- A. - John Couchman -
 - B. - Chester & Beulah Hiler - 2
 - C. - Geo. Hiler - 1
 - D. - J. D. Schradin - 2.6
 - E. - Don Arnold - 5
- SEC. 20
- A. - Leslie & Ora Hiler - 1.63
 - B. - J. D. Schradin - 6.66
- SEC. 21
- A. - Perry C. Leibbrook
 - B. - Edna Leibbrook
 - C. - Florian Muller
 - D. - School - 4.054
 - E. - Morgan Exp. Board of Education - 2
 - F. - Helen G. Dearmond - 2
 - G. - H. Paul Achterman - 1.1277
- SEC. 22
- A. - La Kempt - 1.37
 - B. - R. L. & Alma Kimball - 4.176
 - C. - Cemetery
 - D. - Lewis & Adlene Cuater - 1
- SEC. 23
- A. - Byron E. Dearmond - .49
 - B. - Jos. Miller & Bertha Lee - 1
 - C. - Edna & Wm. Ruddle, et al. - 15.77
 - D. - Chas. T. Dees - 1
 - E. - John Duse - 2.47
 - F. - Ray & Pearl Schoenling - 4
- SEC. 24
- A. - Jennie Wilmer - 1
 - B. - H. H. Robinson, Jr. - .62
 - C. - W. R. Bommer - .51
 - D. - Carl & Bernice Murphy - 10.974
 - E. - H. W. Adams - 10.23
- SEC. 25
- A. - Harry Hiler - 5.45
 - B. - H. H. Robinson, Jr. - 10
 - C. - Allen Evans - .203
 - D. - H. C. Evans - 2.19
 - E. - Florence Francis, et al. - .414
 - F. - Edward G. Fagaly - .699
 - G. - Margaret Fiteck - .699
- SEC. 26
- A. - O. P. Buell - 7.833
 - B. - Ira Burns - 1.17
 - C. - Fred Walter - 4

- SEC. 28
- A. - V. & O. Estridge - 2
 - B. - Marshall Looze - 1.25
 - C. - Don. O. Hamm - 2.85
 - D. - W. P. & Eva Schell - 10.74
 - E. - Shirley Warders - 35.217
 - F. - Thos. & Ida Berry - 2.8
- SEC. 29
- A. - V. & O. Estridge - 5.9
 - B. - T. E. & Patricia Kaufhold - 1
 - C. - H. & F. McCConnell - 2.539
 - D. - Willie Hedrick, et al. - 1.11
 - E. - T. E. & Patricia Kaufhold - .5
 - F. - Shirley Warders - 20
- SEC. 33
- A. - E. & H. Loos - 10
 - B. - Carl Arnold - 3.83
- SEC. 34
- A. - Isaac Walton League - 8
 - B. - Retha Spohler - 18.91
 - C. - Daisy Fowler - 18.91
 - D. - Jos. Burwinkel - 5.14
 - E. - Stan. Schardine - 1.02
 - F. - Nellie Wallace - 3
 - G. - Mary Hodapp, et al. - 18.25
 - H. - John & Martha Jane Roudenbush - .486
- SEC. 35
- A. - J. S. Henderson - .25
- SEC. 36
- A. - Edna Burns - 7.24
 - B. - Russell West - 2
 - C. - Wm. Sunberg - 2.3
 - D. - C. & O. R.R. - .57
 - E. - Dale Shaw - .44
 - F. - C. & O. R.R. - .44
 - G. - U. S. A. - 6.61

- SEC. 28
- A. - V. & O. Estridge - 2
 - B. - Marshall Looze - 1.25
 - C. - Don. O. Hamm - 2.85
 - D. - W. P. & Eva Schell - 10.74
 - E. - Shirley Warders - 35.217
 - F. - Thos. & Ida Berry - 2.8
- SEC. 29
- A. - V. & O. Estridge - 5.9
 - B. - T. E. & Patricia Kaufhold - 1
 - C. - H. & F. McCConnell - 2.539
 - D. - Willie Hedrick, et al. - 1.11
 - E. - T. E. & Patricia Kaufhold - .5
 - F. - Shirley Warders - 20
- SEC. 33
- A. - E. & H. Loos - 10
 - B. - Carl Arnold - 3.83
- SEC. 34
- A. - Isaac Walton League - 8
 - B. - Retha Spohler - 18.91
 - C. - Daisy Fowler - 18.91
 - D. - Jos. Burwinkel - 5.14
 - E. - Stan. Schardine - 1.02
 - F. - Nellie Wallace - 3
 - G. - Mary Hodapp, et al. - 18.25
 - H. - John & Martha Jane Roudenbush - .486
- SEC. 35
- A. - J. S. Henderson - .25
- SEC. 36
- A. - Edna Burns - 7.24
 - B. - Russell West - 2
 - C. - Wm. Sunberg - 2.3
 - D. - C. & O. R.R. - .57
 - E. - Dale Shaw - .44
 - F. - C. & O. R.R. - .44
 - G. - U. S. A. - 6.61