

GENERAL NOTES

1. THE BUTLER COUNTY, AND THE CURRENT EDITION OF THE STATE OF OHIO DEPARTMENT OF TRANSPORTATION CONSTRUCTION AND MATERIAL SPECIFICATIONS (ODOT CMS), INCLUDING ALL AMENDMENTS, SHALL GOVERN ALL MATERIALS AND WORKMANSHIP INVOLVED IN THE IMPROVEMENTS SHOWN ON THIS PLAN. IGNORE REFERENCES TO MEASUREMENT AND PAYMENT IN THE ODOT CMS UNLESS NOTED OTHERWISE. IN THE CASE OF CONFLICTS BETWEEN THE ODOT CMS AND THE BUTLER COUNTY REQUIREMENTS, THE BUTLER COUNTY REQUIREMENTS SHALL PREVAIL.
2. THE CONTRACTOR IS RESPONSIBLE FOR THE INVESTIGATION, LOCATION, SUPPORT, PROTECTION, AND RESTORATION OF ALL EXISTING UTILITIES AND APPURTENANCES WHETHER SHOWN ON THESE PLANS OR NOT. THE CONTRACTOR SHALL EXPOSE ALL UTILITIES OR STRUCTURES PRIOR TO CONSTRUCTION TO VERIFY THE VERTICAL AND HORIZONTAL EFFECT OF ANY CONSTRUCTION. THE CONTRACTOR SHALL CALL FOR THE LOCATION OF THESE UTILITIES PROTECTION SERVICE (1-800-362-2764) 48 HOURS PRIOR TO CONSTRUCTION, AND SHALL NOTIFY ALL UTILITY COMPANIES WHO ARE NON-MEMBERS OF THE OHIO UTILITIES PROTECTION SERVICE AT LEAST 48 HOURS PRIOR TO WORK IN THE VICINITY OF THEIR UNDERGROUND LINES.
3. CONTRACTOR SHALL OBTAIN A PERMIT FOR ALL CONSTRUCTION ACTIVITIES IN ACCORDANCE WITH LOCAL, STATE, & FEDERAL REGULATIONS.
4. THE CONTRACTOR IS TO PERFORM ALL INSPECTIONS AS REQUIRED BY THE OHIO EPA FOR THE NATIONAL POLLUTANT DISCHARGE ELIMINATION SYSTEM (NPDES) PERMIT AND FURNISH OWNERS REPRESENTATIVE WITH WRITTEN REPORTS.
5. THE CONTRACTOR IS REQUIRED TO VISIT THE SITE AND FULLY INFORM HIMSELF CONCERNING ALL ACTIVITIES AFFECTING THE SCOPE OF THE WORK. FAILURE TO VISIT THE SITE SHALL NOT RELIEVE HIM FROM ANY RESPONSIBILITY IN THE PERFORMANCE OF THE CONTRACT.
6. NO ADDITIONAL COMPENSATION SHALL BE ALLOWED FOR EXPENSES INCURRED DUE TO SOIL CONDITIONS, GROUNDWATER, AND/OR ROCK EXCAVATION. ALL OF THESE ITEMS SHALL BE INCLUDED IN THE PRICE BID FOR THE PROJECT.
7. THE COST OF ALL DETWERING REQUIRED FOR THE CONSTRUCTION OF THIS PROJECT SHALL BE INCLUDED IN THE PRICE BID FOR THE PROJECT.
8. THE DIRECT OR INDIRECT DISCHARGE OR PUMPING OF UNFILTERED SEDIMENT-LADEN WATER INTO THE STORM DRAINAGE SYSTEM OR WATERCOURSE IS ILLEGAL AND PROHIBITED.
9. ANY WELL, WELL POINT, PIT, OR OTHER DEVICE INSTALLED FOR THE PURPOSE OF LOWERING THE GROUND WATER TO FACILITATE CONSTRUCTION OF THIS PROJECT SHALL BE PROPERLY ABANDONED IN ACCORDANCE WITH THE PROVISIONS OF SECTION 3745-9-10 OF THE OHIO ADMINISTRATIVE CODE OR IN ACCORDANCE WITH THE PROVISIONS OF THIS PLAN AS DIRECTED BY THE DIRECTOR OF PUBLIC UTILITIES OR HIS REPRESENTATIVE.
10. ANY CONTRACTOR INSTALLING ANY WELL, WELL POINT, PIT, OR OTHER DEVICE USED FOR THE PURPOSE OF LOWERING OR REMOVING GROUND WATER FROM AN AQUIFER SHALL COMPLETE AND FILE A WELL LOG AND DRILLING REPORT FORM WITH THE OHIO DEPARTMENT OF NATURAL RESOURCES (ODNR), DIVISION OF WATER, WITHIN 30 DAYS OF THE WELL COMPLETION IN ACCORDANCE WITH THE OHIO REVISED CODE SECTION 1521.01 AND 1521.05 IN ADDITION, THE CONTRACTOR SHALL SUBMIT IN ACCORDANCE WITH SECTION 1521.01 OF THE OHIO REVISED CODE, FOR COPIES OF THE NECESSARY WELL LOG, DRILLING REPORT, OR REGISTRATION FORMS, PLEASE CONTACT: DIVISION OF WATER, OHIO DEPARTMENT OF NATURAL RESOURCES, FOUNTAIN SQUARE, COLUMBUS, OHIO 43224, (614)2656671.
11. THE CONTRACTOR SHALL BE SOLELY RESPONSIBLE TO THE ODNR FOR THE REGISTRY, MAINTENANCE AND ABANDONMENT OF ANY WITHDRAWAL DEVICE USED IN CONSTRUCTION OF THIS PROJECT.
12. ALL DIMENSIONS ARE TO THE EDGE OF PAVEMENT AND/OR FACE OF CURB, UNLESS OTHERWISE NOTED.
13. ALL SITE SIGNAGE, STRIPING COLOR AND WIDTH SHALL BE PER THE OHIO MANUAL OF UNIFORM TRAFFIC CONTROL DEVICES.
14. ALL EXISTING PAVEMENTS, WALKS, CURBS, ETC. SHALL BE SAWCUT BEFORE REMOVAL. IF, DURING CONSTRUCTION, THE PAVEMENT, WALKWAY, CURB, ETC. IS DAMAGED BEYOND THE ODOT SPECIFIC PRODUCT, THE DAMAGE SHALL BE REPAIRED TO NEAT LINE AS DIRECTED BY THE ENGINEER. PAYMENT FOR SAWCUTTING SHALL BE INCLUDED IN THE PRICE BID FOR THE PROJECT.
15. THE CONTRACTOR SHALL SAWCUT EXISTING PAVEMENT TO PROVIDE A SMOOTH VERTICAL FULL DEPTH BUTT JOINT BETWEEN THE EXISTING PAVEMENT OR CURB AND THE PROPOSED PAVEMENT. CONTRACTOR SHALL LOCATE SLOPE PAVEMENT EDGE AND CUT AND TRIM PAVEMENT TO ACHIEVE THE DESIRED COST OF PAVEMENT REMOVAL AND DISPOSAL IN THE PRICE BID FOR THE PROJECT.

GRADING NOTES

1. CONTRACTOR TO REMOVE TREES AND CLEAR AREAS AS NECESSARY TO PERFORM ALL SITE WORK INCLUDING GRADING AND UTILITY WORK.
2. PROTECTION OF EXISTING TREES AND VEGETATION: PROTECT EXISTING TREES AND OTHER VEGETATION INDICATED TO REMAIN IN PLACE AGAINST UNNECESSARY CUTTING, BREAKING OR REMOVAL OF BRANCHES OR BRUISING OF BARK, SMOTHERING OF TREES BY STOCKPILING CONSTRUCTION MATERIALS OR EXCAVATED MATERIALS WITHIN DRIP LINE, EXCESS FOOT OR VEHICULAR TRAFFIC, OR PARKING OF VEHICLES WITHIN DRIP LINE. PROVIDE TEMPORARY GUARDS TO PROTECT TREES AND VEGETATION TO BE LEFT STANDING.
3. ALL ELEVATIONS SHOWN ARE FINISHED GRADE ELEVATIONS.
4. ALL FILL UNDER PAVEMENT SHALL BE COMPACTED TO THE GEOTECHNICAL ENGINEER'S RECOMMENDATIONS.
5. THE CONTRACTOR IS RESPONSIBLE FOR BALANCING THE SITE EARTHWORK ON SITE. THE CONTRACTOR IS RESPONSIBLE FOR BURY/BORROW PITS AS NEEDED TO BALANCE THE SITE. GEOTECH AND ENGINEER MUST APPROVE AREAS PRIOR TO BURY/BORROW OPERATIONS. AS-BUILT OF BURY/BORROW PIT WILL BE REQUIRED AT COMPLETION OF CONSTRUCTION WORK AND MUST BE SUBMITTED TO THE CONSTRUCTION MANAGER.
6. CONTRACTOR SHALL IMPLEMENT ALL SOIL AND EROSION CONTROL PRACTICES REQUIRED BY BUTLER COUNTY AND THE OHIO EPA.
7. ALL GROUND SURFACE AREAS THAT HAVE BEEN EXPOSED OR LEFT BARE AS A RESULT OF CONSTRUCTION AND ARE TO FINAL GRADE AND ARE TO REMAIN SO, SHALL BE SEEDDED AND MULCH SOIL SURFACE PROTECTION AND STABILIZATION WITH THE PROJECT SPECIFICATIONS. NO SPECIFICATIONS ARE SUPPLIED, USE ODOT ITEM 659.

UTILITY NOTES

1. ALL DRAIN TILE AND STORM SEWERS DAMAGED, DISTURBED OR REMOVED AS A RESULT OF THE CONTRACTOR'S OPERATIONS SHALL BE REPLACED WITH THE SAME QUALITY PIPE OR BETTER, MAINTAINING THE SAME GRADIENT AS EXISTING. THE DRAIN TILE AND/OR STORM SEWER SHALL BE CONNECTED TO THE CURB SUDS/RAMP, STORM SEWER SYSTEM OR OUTLETED INTO THE ROADWAY DITCH AS APPLICABLE. REPLACED DRAIN TILE AND/OR SEWER SHALL BE LAID ON COMPACTED BEDDING EQUAL IN DENSITY TO SURROUNDING STRATUM. REPLACEMENT SHALL BE DONE AT THE TIME OF THE BACKFILL OPERATION. COST OF THIS WORK TO BE INCLUDED IN THE PRICE BID FOR THE PROJECT.
2. ALL EXISTING UTILITIES KNOWN TO EXIST HAVE BEEN SHOWN ON THESE PLANS IN THEIR APPROXIMATE LOCATION. PRIOR TO THE BEGINNING OF CONSTRUCTION OR EARTH MOVING OPERATIONS, THE CONTRACTOR SHALL DETERMINE THE LOCATION AND ELEVATION OF THE UTILITIES SHOWN. THE CONTRACTOR IS ALSO RESPONSIBLE FOR THE PROTECTION AND/OR RELOCATION OF ANY UTILITIES THAT MAY EXIST AND ARE NOT SHOWN.
3. THE CONTRACTOR SHALL BE RESPONSIBLE FOR COORDINATING THE RELOCATION AND/OR PROTECTION OF ANY UTILITIES AS REQUIRED BY THE PLAN WITH THE OWNER OF THE AFFECTED UTILITY.
4. UTILITY POLES WITHIN INFLUENCE OF THE UTILITY OPERATIONS SHALL BE REINFORCED BY THE UTILITY COMPANY PRIOR TO THESE CONSTRUCTION ACTIVITIES. NOTIFICATION OF THE UTILITY COMPANY PRIOR TO CONSTRUCTION SHALL BE THE RESPONSIBILITY OF THE CONTRACTOR.
5. ADJUST ALL EXISTING CASTINGS AND CLEANOUTS WITHIN PROJECT AREA TO GRADE AS REQUIRED.
6. ALL CATCH BASINS WITH DEPTH GREATER THAN 4.5' SHALL BE PROVIDED WITH STEPS. STEPS SHALL MEET THE REQUIREMENTS OF ODOT ITEM 611.
7. ALL STORM AND SANITARY SEWER MANHOLES WITH A DEPTH GREATER THAN 4' SHALL BE PROVIDED WITH STEPS. STEPS SHALL MEET THE REQUIREMENTS OF ODOT ITEM 611.
8. DISTANCES SHOWN FOR BOTH SANITARY AND STORM SEWER PIPES ARE MEASURED FROM CENTER OF STRUCTURE. THE CONTRACTOR IS RESPONSIBLE FOR ACTUAL FIELD CUT LENGTH. COORDINATES FOR STORM AND SANITARY STRUCTURES ARE SHOWN TO THE CENTER OF STRUCTURE, UNLESS OTHERWISE NOTED.
9. IMMEDIATELY AFTER PLACEMENT OF ANY CONDUITS, THE CONTRACTOR SHALL CONSTRUCT THE END TREATMENTS REQUIRED BY THE PLANS AT BOTH THE OUTLET AND INLET ENDS. THIS SHALL INCLUDE HEADWALLS, CONCRETE, RIP RAP, ROCK CHANNEL PROTECTION, SODDING, POURING BOTTOMS, MUDDING LIFT HOLES, ETC.
10. ALL PROPOSED STORM SEWERS, SURFACE OR OTHER DRAINAGE FACILITIES ARE TO BE PRIVATE AND MAINTAINED BY THE OWNER. EROSION CONTROL MEASURES MUST PROVIDE PROTECTION UNTIL COMPLETION OF THE PROJECT AND VEGETATIVE STABILIZATION.
11. ALL STORM STRUCTURES ARE ODOT TYPES UNLESS OTHERWISE INDICATED.

12. STORM SEWER PIPE LABELED "STM" SHALL BE ONE OF THE FOLLOWING: PVC SDR-35 PER ODOT ITEM 707.45, PVC PROFILE PIPE PER ODOT ITEM 707.43, HIGH DENSITY POLYETHYLENE PER ODOT ITEM 707.33, ALUMINIZED CORRUGATED METAL, ODOT ITEM 707.01, 707.02, OR REINFORCED CONCRETE PIPE, ODOT ITEM 706.02 CLASS IV. STORM

SEWER PIPE LABELED "RCP" SHALL BE REINFORCED CONCRETE PIPE, ODOT ITEM 706.02 CLASS IV. ALL STORM IS TO BE INSTALLED PER ODOT ITEM 611. ALL STORM PIPE USED MUST HAVE A MANUFACTURER SPECIFIED FRICTION FACTOR OF 0.013 ($N=0.013$) OR LESS.

13. ALL EXISTING INVERTS ALONG PROPOSED PIPE ALIGNMENTS SHALL BE VERIFIED BY THE CONTRACTOR PRIOR TO CONSTRUCTION OF THE SEWER.
14. ANY FIELD TILE CUT IN EXCAVATION WHICH DRAINS IN AN OFFSITE AREA MUST BE TIED INTO THE STORM DRAINAGE SYSTEM.
15. THE FLOW IN ALL SEWERS, DRAINS, FIELD TILES AND WATERCOURSES ENCOUNTERED SHALL BE
16. MAINTAINED BY THE CONTRACTOR AT HIS OWN EXPENSE, AND WHENEVER SUCH WATERCOURSES AND DRAINS ARE DISTURBED OR DESTROYED DURING THE PROSECUTION OF THE WORK, THEY SHALL BE RESTORED BY THE CONTRACTOR AT HIS OWN EXPENSE TO A CONDITION SATISFACTORY TO THE ENGINEER.
17. SANITARY SEWER SHALL BE SDR-35 OR APPROVED EQUAL AND CONFORM TO THE STANDARDS AND SPECIFICATIONS OF BUTLER COUNTY. PIPE MUST MEET MINIMUM SLOPE REQUIREMENTS OF BUTLER COUNTY AND OHIO EPA. SANITARY SEWER SHALL BE INSTALLED AT A MINIMUM DEPTH OF FOUR FEET (4') UNLESS OTHERWISE NOTED. A MINIMUM OF 18" OF BEDDING SHALL BE PROVIDED AT ALL WATERLINE CROSSINGS. SANITARY SERVICE JOINTS SHALL CONFORM TO ASTM D-3212.
18. SANITARY SEWER IS TO BE BEDDED WITH CLEAN GRANULAR MATERIAL-AGGREGATES NOT TO BE LARGER THAN 3/4" AND NOT SMALLER THAN NO. 8 SIEVE, FREE OF SILT AND FINES, AASHTO M43 SIZE #67, 7 OR 8. BEDDING TO BE MINIMUM OF 6" BELOW & 12" ABOVE THE PIPE.

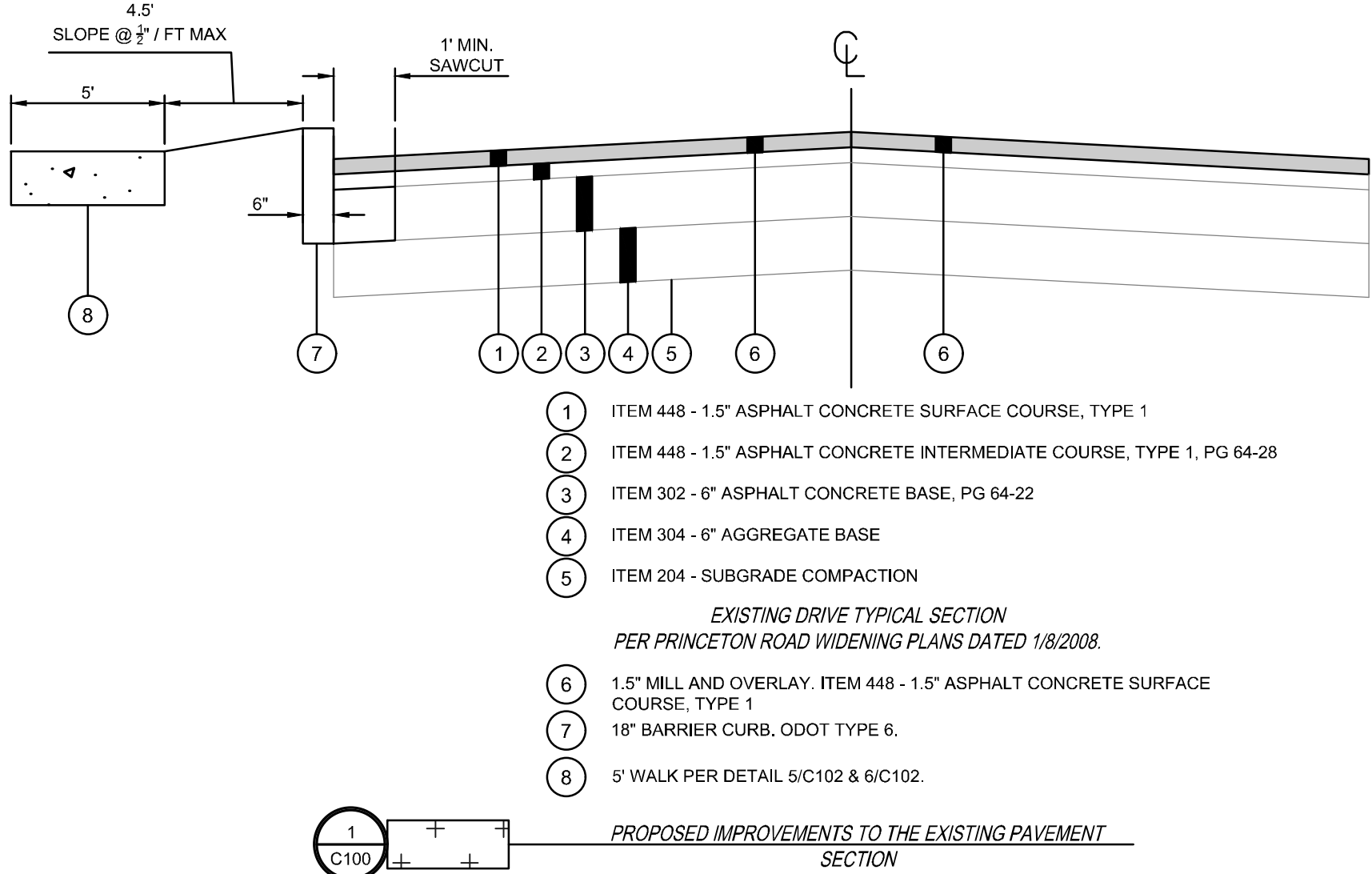
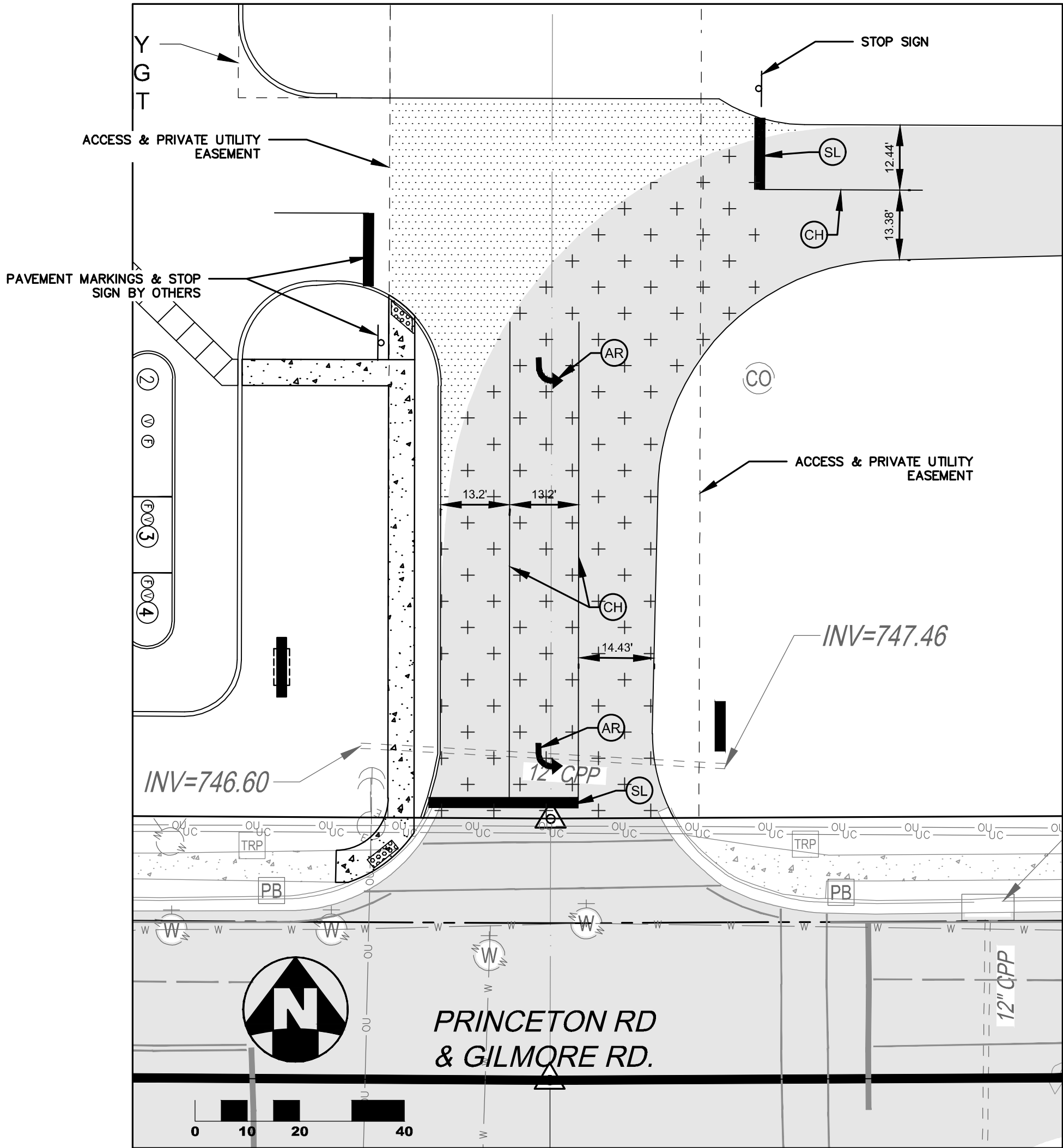

BRIDGEWATER CHURCH SUBDIVISION

SECTIONS 20 & 26, T-2, R-3, BTM
FAIRFIELD TOWNSHIP BUTLER COUNTY, OHIO

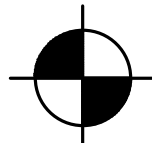

PROJECT BENCHMARK:

BOX CUT BENCHMARK @ TRAFFIC POLE, INTERSECTION OF
GILMORE RD. & PRINCETON RD.
ELEV: 642.52

CROSS NOTCH IN SIDEWALK @ INTERSECTION OF GILMORE RD. &
PRINCETON RD.
N: 12,036.83 E: 10,385.88

PAVEMENT MARKING LEGEND

④ ITEM 644—CHANNELIZING LINE, WHITE, 8"

⑤ ITEM 644—STOP LINE, WHITE, 24"

Ⓐ ITEM 644-LANE ARROWS, WHITE

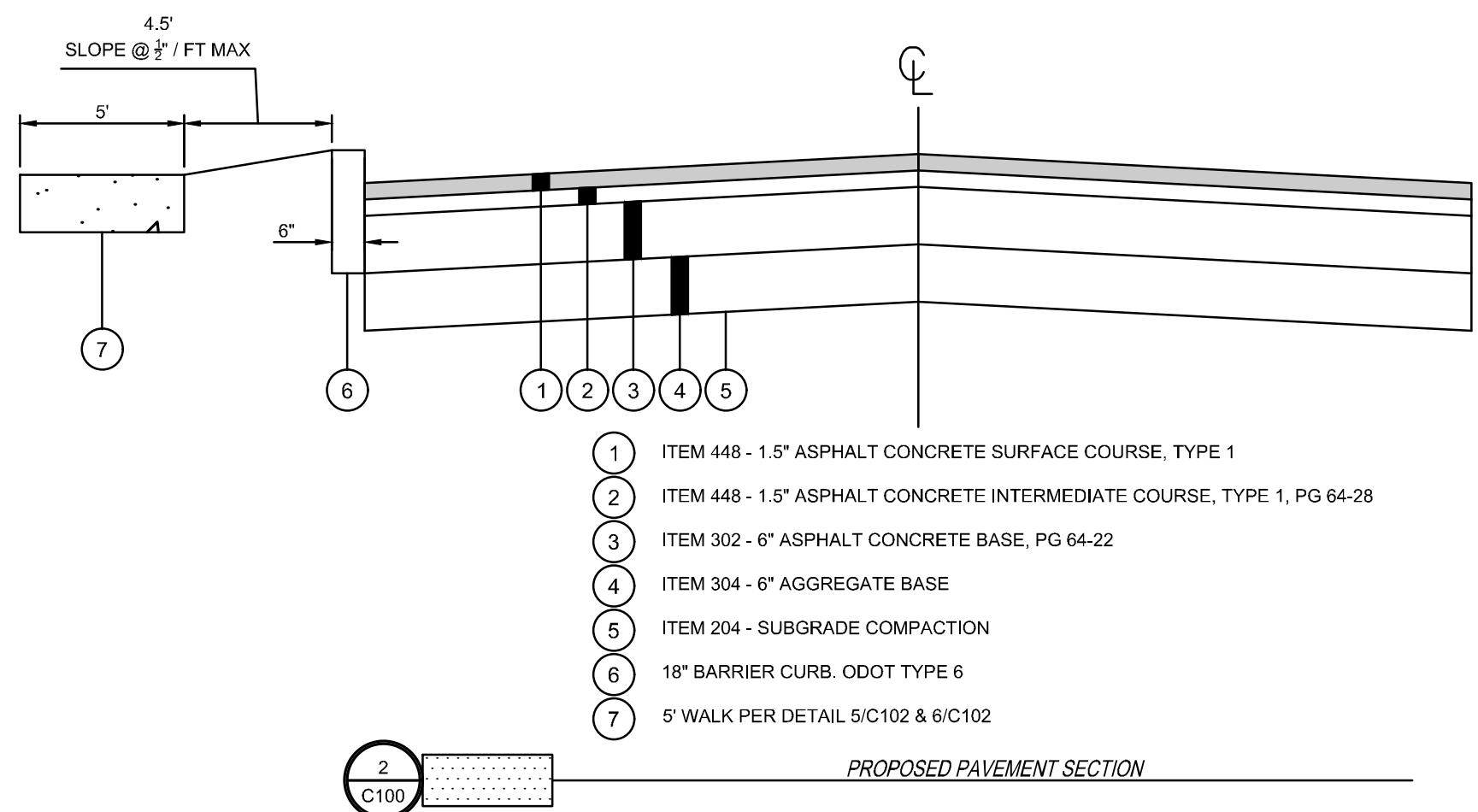

<u>DRAWING INDEX</u>	
SHEET	TITLE
C100	TITLE SHEET
C101	GENERAL NOTES & DETAILS
C102	GENERAL NOTES & DETAILS
C110	SURVEY BASEMAP
C140	LOCATION & UTILITY PLAN
C141	UTILITY PROFILES & DETAILS
C150	GRADING PLAN & SWPPP
C151	EROSION CONTROL NOTES & DETAILS
C152	EROSION CONTROL NOTES & DETAILS
C153	SWPPP LOG

OWNER / DEVELOPER

FIRST CHURCH OF GOD
OF HAMILTON OHIO
3100 PRINCETON RD.
HAMILTON, OHIO 45011
CONTACT: DREW WILKERSON
513-867-9961

ENGINEER / SURVEYOR

THE KLEINGERS GROUP
6219 CENTRE PARK DRIVE
WEST CHESTER, OHIO 45069
(513) 779-7851



CIVIL ENGINEERING www.kleingers.com
SURVEYING 6305 Centre Park Dr.
LANDSCAPE West Chester, OH 45069
ARCHITECTURE 513.779.7851



EJP 02/18/2021

1) CRITICAL FLOOD ROUTE AT SOUTH
END OF SITE, DRAIN TO SIDE YARD
SWALE AND NOT INTO PRINCETON
ROAD VIA DRIVEWAY ACCESS.
2) AN ESC EARTH MOVING PERMIT IS
REQUIRED PRIOR TO START OF
CLEARING OPERATIONS.
3) AS PART OF PHASE 2, NOTE & SHOW
FUTURE SIDEWALK, SERVICE DRIVE
EXTENSION, AND RELOCATED FUEL
CENTER DRIVEWAY ON SHEET C-140.

SEAL

[illegible]

**BRIDGEWATER
CHURCH
SUBDIVISION
FAIRFIELD TOWNSHIP
BUTLER COUNTY, OHIO**

PROJECT NO: 180075.000

DATE: 12/18/2020

SCALE.

SHEET NAME.

TITLE SHEET

SHEET NO.

C100

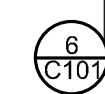
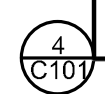
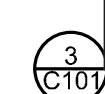
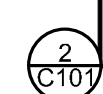
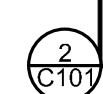
[illegible]



**Know what's below.
Call before you dig.**



C110

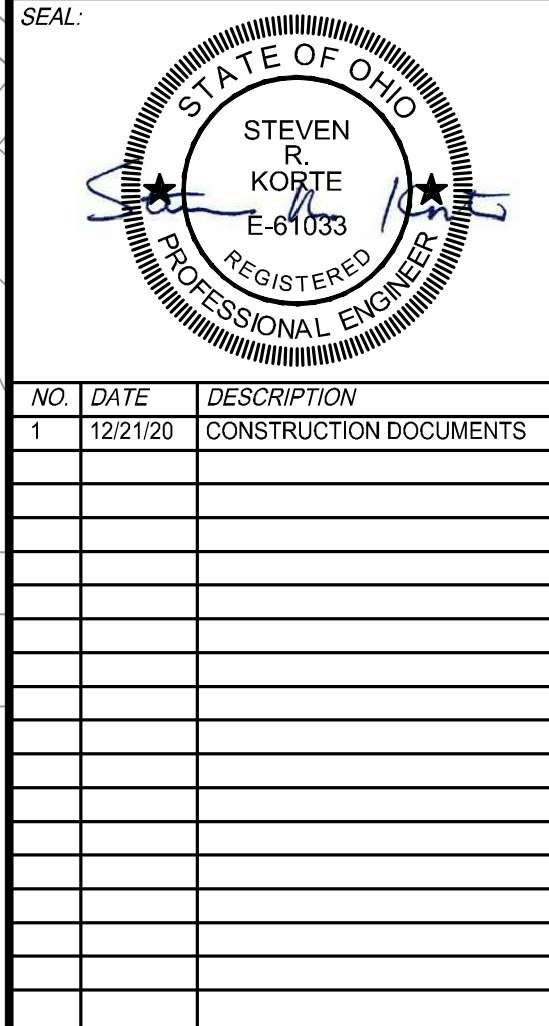

PROJECT NO:	180075.000
DATE:	12/18/2020
SCALE:	
SHEET NAME:	

SHEET NO.

C140

NOTE:
UNDERGROUND UTILITIES ARE PLOTTED FROM A
COMPILATION OF AVAILABLE RECORD INFORMATION, GIS AND
SURFACE INDICATIONS OF UNDERGROUND STRUCTURES
AND MAY NOT BE INCLUSIVE. PRECISE LOCATIONS AND
THE EXISTENCE OR NON EXISTENCE OF UNDERGROUND UTILITIES
CANNOT BE VERIFIED. PLEASE NOTIFY THE KENTUCKY
UTILITY PROTECTION SERVICE AT 1-800-752-6007 BEFORE
ANY PERIOD OF EXCAVATION OR CONSTRUCTION ACTIVITY.

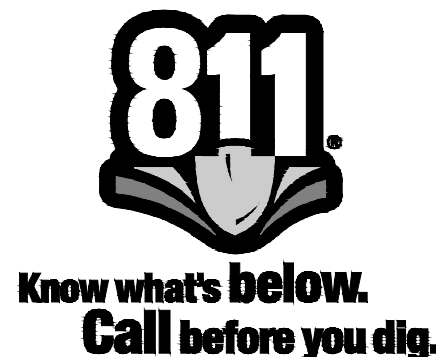



SCALE:

GRADING PLAN & SWPPP

C150

[illegible]

NOTE:
UNDERGROUND UTILITIES ARE PLOTTED FROM A
COMPILATION OF AVAILABLE RECORD INFORMATION. GIS AND
SURFACE INDICATIONS OF UNDERGROUND STRUCTURES
AND MAY NOT BE INCLUSIVE. PRECISE LOCATIONS AND THE
EXISTENCE OR NON EXISTENCE OF UNDERGROUND UTILITIES
CANNOT BE VERIFIED. PLEASE NOTIFY THE KENTUCKY
UTILITY PROTECTION SERVICE AT 1-800-752-6007 BEFORE
ANY PERIOD OF EXCAVATION OR CONSTRUCTION ACTIVITY.



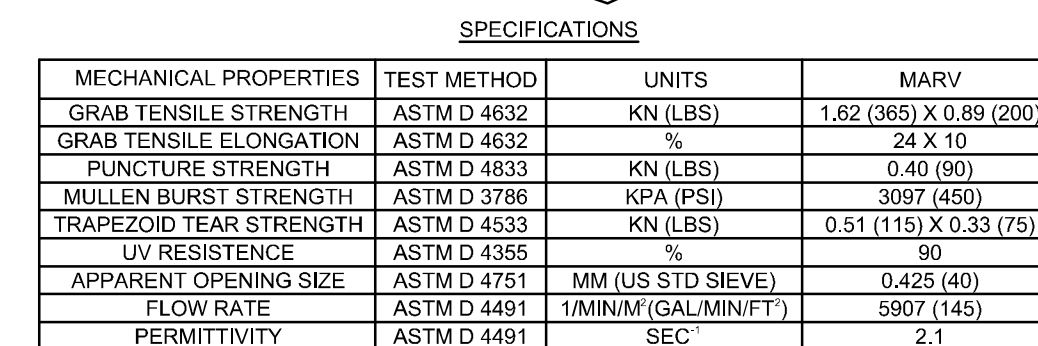
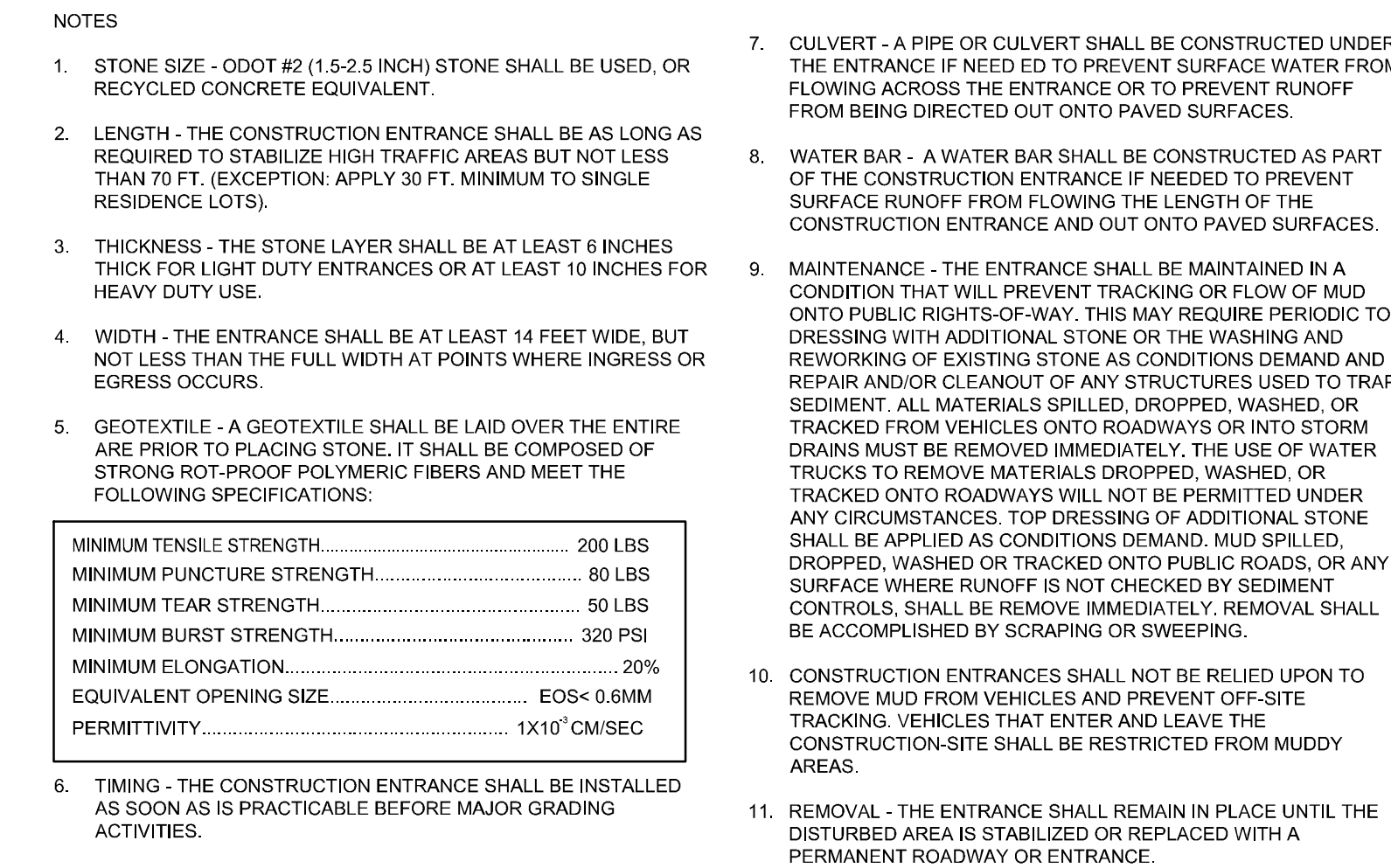

INSTALLATION: THE EMPTY DANDY BAG SHOULD BE PLACED OVER THE GRATE AS THE GRATE STANDS ON END. IF USING OPTIONAL OIL ABSORBENTS: PLACE ABSORBENT PILLOW IN POUCH, ON THE BOTTOM (BELOW-GRADE SIDE) OF THE UNIT. ATTACH ABSORBENT PILLOW TO TETHER LOOP. TUCK THE ENCLOSURE FLAP INSIDE TO COMPLETELY ENCLOSE THE GRATE. HOLDING THE LIFTING DEVICES (DO NOT RELY ON LIFTING DEVICES TO SUPPORT THE ENTIRE WEIGHT OF THE GRATE). PLACE THE GRATE INTO ITS FRAME.

MAINTENANCE: REMOVE ALL ACCUMULATED SEDIMENT AND DEBRIS FROM SURFACE AND VICINITY OF UNIT AFTER EACH STORM EVENT. REMOVE SEDIMENT THAT HAS ACCUMULATED WITHIN THE CONTAINMENT AREA OF THE DANDY BAG AS NEEDED. IF USING OPTIONAL OIL ABSORBENTS; REMOVE AND REPLACE ABSORBENT PILLOW WHEN NEAR SATURATION.



NORTH TEMPORARY SEDIMENT BASIN SEDIMENT VOLUME
1000 CF PER ACRE OF TOTAL DISTURBED AREA
1000 CF/AC * 19.74 AC = 19,740 CF
SEDIMENT STORAGE ELEVATION = 726.91
BOTTOM OF BASIN ELEVATION = 725
VOLUME PROVIDED = 19,740 CF

NOTES:		EMBANKMENT OR EMERGENCY SPILLWAY REMAIN BARE FOR MORE THAN 7 DAYS.
<p>1. SEDIMENT BASINS SHALL BE CONSTRUCTED AND OPERATIONAL BEFORE UP-SLOPE LAND DISTURBANCE BEGINS.</p> <p>2. SITE PREPARATION -THE AREA UNDER THE EMBANKMENT SHALL BE CLEARED, GRUBBED, AND STRIPPED OF ANY VEGETATION AND ROOT MAT. THE POOL AREA SHALL BE CLEARED AS NEEDED TO FACILITATE SEDIMENT CLEANOUT. GULLIES AND SHARP BARRS SHALL BE SLOPED TO NO STEEPER THAN 1:1. THE SURFACE OF THE FOUNDATION AREA WILL BE THOROUGHLY SCARIFIED BEFORE PLACEMENT OF THE EMBANKMENT MATERIAL.</p>	<p>9. SEDIMENT CLEANOUT -SEDIMENT SHALL BE REMOVED AND THE SEDIMENT BASIN RESTORED TO ITS ORIGINAL DIMENSIONS WHEN SEDIMENT HAS FILLED ONE-HALF THE POND'S ORIGINAL DEPTH AS INDICATED ON THE PLANS. SEDIMENT REMOVED FROM THE BASIN SHALL BE PLACED SO THAT IT WILL NOT ERODE.</p> <p>10. FINAL REMOVAL - SEDIMENT BASINS SHALL BE REMOVED AFTER THE UPSTREAM DRAINAGE AREA IS STABILIZED OR AS INDICATED IN THE PLANS. DEWATERING AND REMOVAL SHALL NOT CAUSE SEDIMENT TO BE DISCHARGED. THE SEDIMENT BASIN SITE AND SEDIMENT REMOVED FROM THE BASIN SHALL BE STABILIZED.</p>	
<p>3. CUT-OFF TRENCH -THE CUTOFF TRENCH SHALL BE EXCAVATED ALONG THE CENTERLINE OF THE EMBANKMENT. THE MINIMUM DEPTH SHALL BE 3 FT., UNLESS SPECIFIED DEEPER ON THE PLANS OR AS A RESULT OF SITE CONDITIONS. THE MINIMUM BOTTOM WIDTH SHALL BE 4 FT., BUT WIDE ENOUGH TO PERMIT OPERATION OF COMPACTATION EQUIPMENT. THE TRENCH SHALL BE KEPT FREE OF STANDING WATER DURING BACKFILL OPERATIONS.</p>	<p>OPERATION & MAINTENANCE:</p> <p>SEDIMENT BASINS SHALL BE INSPECTED ON A WEEKLY BASIS AND AFTER EACH RUNOFF EVENT. NECESSARY ACTIVITIES ARE SHOWN AS FOLLOWS:</p>	
<p>4. EMBANKMENT -THE FILL MATERIAL SHALL BE FREE OF ALL SOD, ROOTS, FROZEN SOIL, STONES OVER 6 IN. IN DIAMETER, AND OTHER OBSTRUCTIVE MATERIAL. THE FILL SHALL BE PLACED AND SPREADING OF THE FILL MATERIAL SHALL BE STARTED AT THE LOWEST POINT OF THE FOUNDATION AND THE FILL SHALL BE BROUGHT UP IN APPROXIMATELY 6 IN. HORIZONTAL LAYERS OR OF SUCH THICKNESS THAT THE REQUIRED COMPACTATION CAN BE OBTAINED WITH THE EQUIPMENT USED. CONSTRUCTION EQUIPMENT SHALL BE OPERATED OVER EACH LAYER IN A WAY THAT WILL RESULT IN THE REQUIRED COMPACTATION. SPECIAL EQUIPMENT SHALL BE USED WHEN THE REQUIRED COMPACTATION CANNOT BE OBTAINED WITHOUT IT. THE MOISTURE CONTENT OF FILL MATERIAL SHALL BE SUCH THAT THE REQUIRED DEGREE OF COMPACTATION CAN BE OBTAINED WITH THE EQUIPMENT USED.</p>	<p>1. ESTABLISH VEGETATIVE COVER AND FERTILIZE AS NECESSARY TO MAINTAIN A VIGOROUS COVER IN AND AROUND THE SEDIMENT BASIN.</p> <p>2. REMOVE UNDESIRABLE VEGETATION PERIODICALLY TO PREVENT GROWTH OF TREES AND SHRUBS ON THE EMBANKMENT AND SPILLWAY AREAS.</p> <p>3. PROMPTLY REPAIR ERODED AREAS. REESTABLISH VEGETATIVE COVER IMMEDIATELY WHERE SCOUR EROSION HAS REMOVED ESTABLISHED SEEDING.</p> <p>4. PROMPTLY REMOVE ANY BURROWING RODENTS THAT MAY INVADE AREAS OF THE EMBANKMENT.</p>	
<p>5. PIPE SPILLWAY -THE PIPE CONDUIT BARREL SHALL BE PLACED ON A FIRM FOUNDATION TO THE LINES AND GRASSES SHOWN ON THE PLANS. CONNECTIONS BETWEEN THE RISER AND BARREL, THE ANTISEEP COLLARS AND BARREL, AND ALL PIPE JOINTS SHALL BE WATERTIGHT. SELECTED BACKFILL MATERIAL SHALL BE USED TO FILL THE PIPE CONDUIT IN LAYERS AND EACH LAYER SHALL BE COMPACTED TO AT LEAST THE SAME DENSITY AS THE ADJACENT EMBANKMENT. ALL COMPACTATION WITHIN AND ON TOP OF THE SPILLWAY SHALL BE ACCOMPLISHED WITH HAND-OPERATED TAMPING EQUIPMENT.</p>	<p>5. REMOVE TRASH AND DEBRIS THAT MAY BLOCK SPILLWAYS AND ACCUMULATE IN THE POND.</p> <p>6. REMOVE SEDIMENT FROM BASIN WHEN IT FILLS THE DESIGN DEPT. THE SEDIMENT STORAGE ZONE. THIS ELEVATION SHALL BE MARKED ON A CLEANOUT STAKE NEAR THE CENTER OF THE BASIN.</p> <p>CHECK SPILLWAY OUTLETS AND POINTS OF INFLOW TO ENSURE DRAINAGE IS NOT CAUSING EROSION AND THAT OUTLET'S ARE NOT CLOGGED. REPLACE DISPLACED RIPRAP IMMEDIATELY.</p>	
<p>6. TRASH RACKS -THE TOP OF THE RISER SHALL BE FITTED WITH TRASH RACKS FIRMLY FASTENED TO THE RISER PIPE.</p>	<p>8. AFTER THE ENTIRE CONSTRUCTION PROJECT IS COMPLETED, TEMPORARY SEDIMENT BASINS SHOULD BE DEWATERED AND REGRADED TO CONFORM TO THE CONTOURS OF THE AREA. ALL TEMPORARY STRUCTURES SHOULD BE REMOVED AND THE AREA SEEDED, MULCHED AND STABILIZED AS NECESSARY.</p>	
<p>7. EMERGENCY SPILLWAY - THE EMERGENCY SPILLWAY SHALL BE CUT IN UNDISTURBED GROUND. AN IMMEDIATE ACTION OF THE SPILLWAY ELEVATION AND WIDTH IS CRITICAL AND SHALL BE WITHIN A TOLERANCE OF 0.2 FT.</p>		
<p>8. SEED AND MULCH -THE SEDIMENT BASIN SHALL BE STABILIZED IMMEDIATELY FOLLOWING ITS CONSTRUCTION. IN NO CASE SHALL THE</p>		

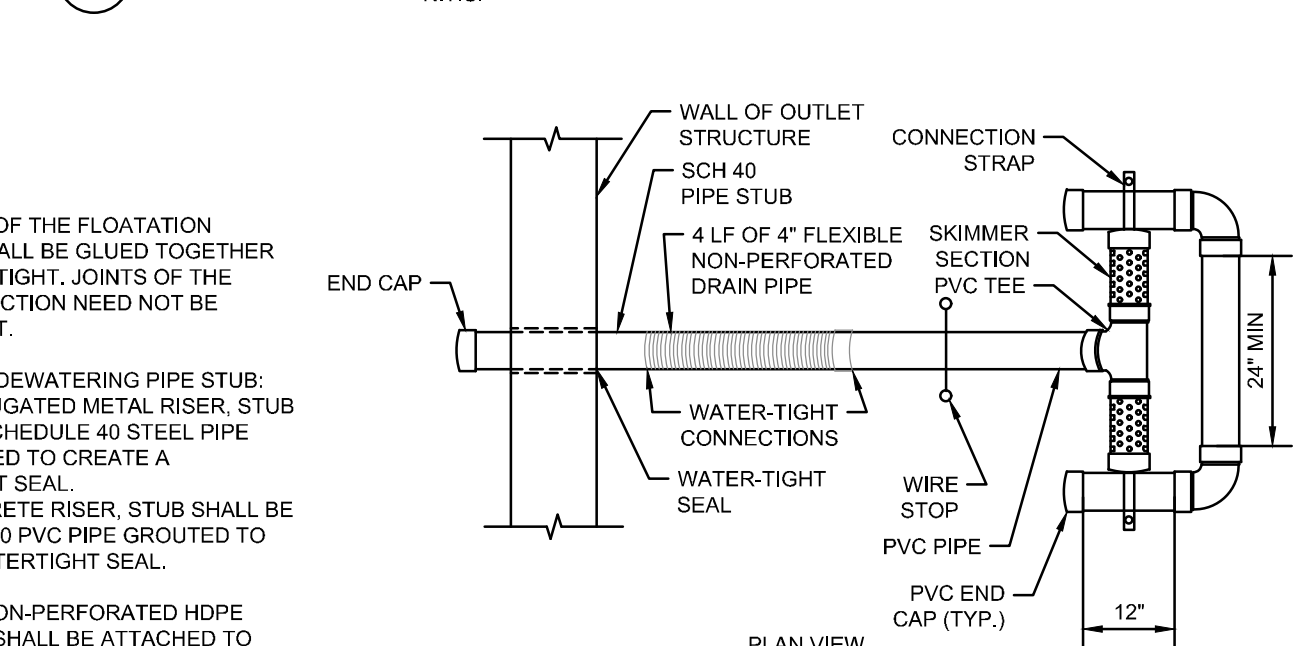

WATERTIGHT CONNECTIONS.

TO BE 3" DIAMETER FOR A
HOUR DEWATERING TIME.

#4 REBAR GUIDE POST
WITH WIRE STOP AT
DESIGN HIGH WATER = 72'



CORRECTIVE ACTION LOG

GRADING AND STABILIZATION LOG

GRADING AND STABILIZATION LOG

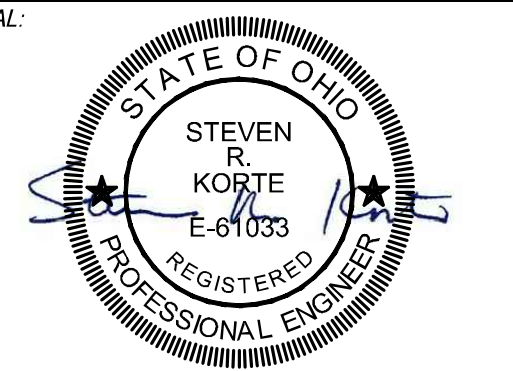

**BRIDGEWATER
CHURCH
SUBDIVISION
FAIRFIELD TOWNSHIP
BUTLER COUNTY, OHIO**

SWPPP LOG

SHEET NO.

C153