

Plot time: Jul 22, 2008 - 12:45pm
 Drawing name: \\V2007\07M097-000\CADWG\07M097-000 GRADING.dwg - Layout Tab: DRAINAGE MAPS

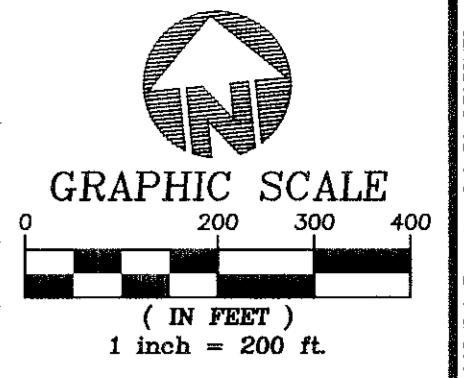
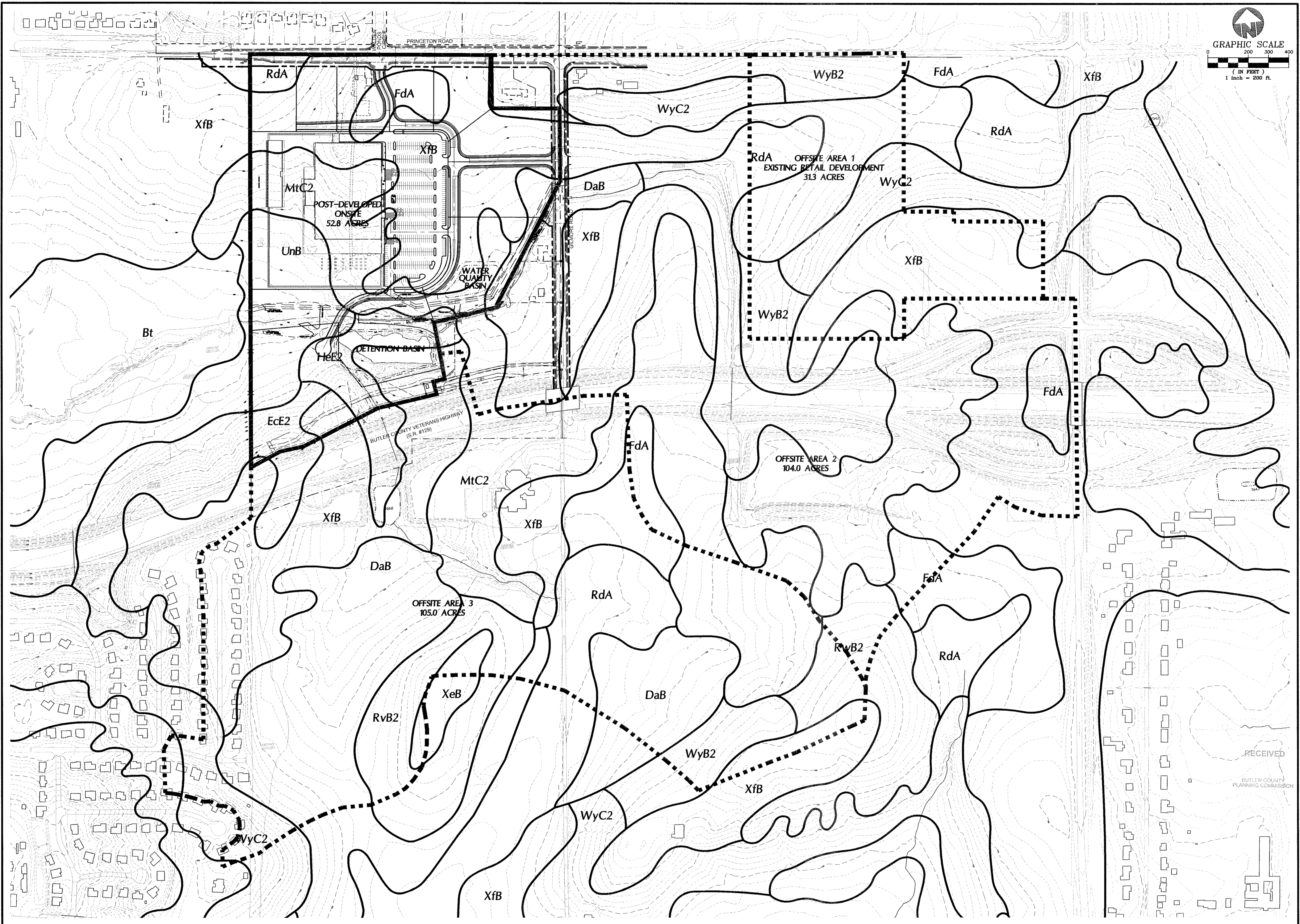

<p>THE FOUNTAINS OF FAIRFIELD TOWNSHIP 2865 PRINCETON ROAD SECTION 25, TOWN 2, RANGE 3 FAIRFIELD TOWNSHIP, BUTLER COUNTY, OHIO</p>	
<p>SOILS MAP</p>	
<p>RECEIVED BUTLER COUNTY PLANNING COMMISSION</p>	<p>bayer becker www.bayerbecker.com 6600 Tylersville Road, Suite A Mason, OH 45040 - 513.336.6600</p>
<p>Drawing: 07M097-000 GRADING Drawn by: GJK Checked by: Issue Date: 7-18-08 Sheet:</p>	<p>1</p>

THIS DOCUMENT AND ALL RELATED DATA, DRAWINGS, REPORTS, AND ELECTRONIC MEDIA PREPARED OR PURCHASED BY BAYER BECKER ARE THE SOLE PROPERTY OF BAYER BECKER AND SHALL REMAIN THE PROPERTY OF BAYER BECKER. NO PART MAY BE REPRODUCED, COPIED, OR TRANSMITTED IN ANY FORM OR BY ANY MEANS, ELECTRONIC OR MECHANICAL, INCLUDING PHOTOCOPYING, RECORDING, OR BY ANY INFORMATION STORAGE AND RETRIEVAL SYSTEM, WITHOUT THE WRITTEN PERMISSION OF BAYER BECKER.