

From: "Bob Bailey" <bobbailey@bayerbecker.com>
To: "Teresa Barnes" <BarnesT@bceo.org>
Date: 10/27/05 8:36AM
Subject: Chesterwood Drainage[Scanned]

Teresa,

Attached is a pdf file of the drainage at the Chesterwood west retention basin. This is in response to your comments about verification that the flood route from the east basin is going down the street to a low point and then into the west basin. Based on the fieldwork that we got in the area and the Butler County topo outside that area, it does appear that the water will enter the west basin. The Butler County topo appears to be in close agreement with the topo that we did. There is a swale south of the street and catch basins which does drain toward the west basin.

Please look this drawing over and advise us if this is or is not acceptable. I will be out of the office beginning tomorrow for two weeks, but if you need to discuss the topo with anyone before I return on the 14th, please contact Leslie Bailer in my office.

If you have any questions or need any further information, let me know.

Thanks,

Bob

Robert W. Bailey, P. E.

Project Manager

Bayer Becker, Inc.

700 Nilles Road

Fairfield, OH 45014

Phone: (513) 829-2149

Fax: (513) 829-2457

Email: bobbailey@bayerbecker.com

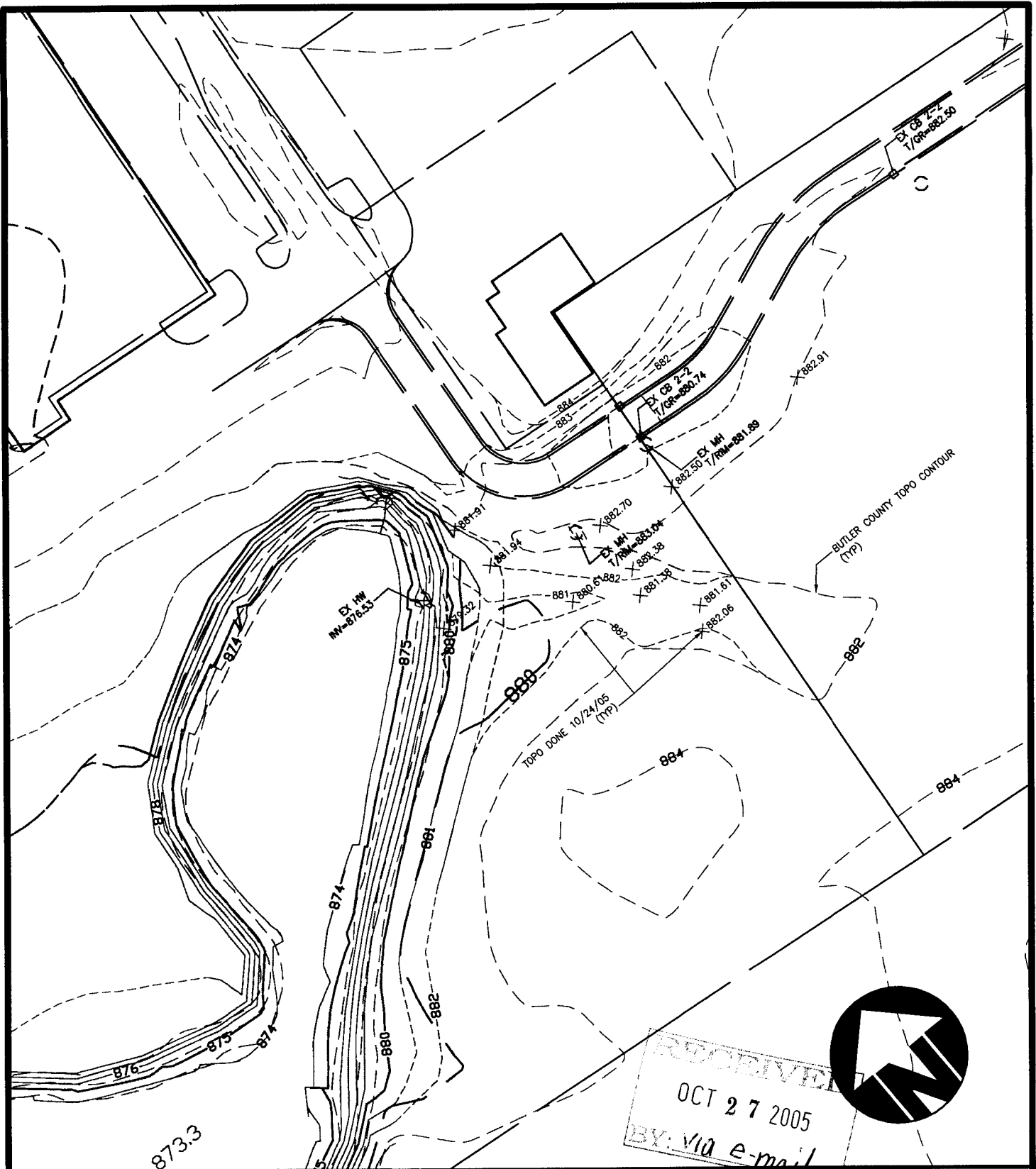

RECEIVED
OCT 27 2005
BY: via e-mail

Drawing:	05F077DR
Scale	1" = 100'
Drawn by:	JLR
Checked By:	RWB
Issue Date:	10/24/05

CHESTERWOOD DRAINAGE ROUTE

WEST CHESTER TWP, BUTLER CO., OH
SECTION 11, TOWN 3, RANGE 2

WEST BASIN DETAIL

bayer becker

700 Nilles Road
Fairfield, OH 45014 - 513.829.2149